

We encourage everyone to view the meeting live via YouTube.

***Leavenworth County  
Board of County Commissioners***

***Regular Meeting Agenda***  
300 Walnut Street, Suite 225  
Leavenworth, KS 66048  
May 7, 2025  
9:00 a.m.

- I. CALL TO ORDER
- II. PLEDGE OF ALLEGIANCE/MOMENT OF SILENT PRAYER
- III. ROLL CALL
- IV. PUBLIC COMMENT: Public Comment shall be limited to 25 minutes at the beginning of each meeting and limited to five minutes per person. Anyone wishing to make comments either on items on the agenda or not are encouraged to provide their comments in writing no later than 8:00 AM the Monday immediately preceding the meeting. These comments will be included in the agenda packet for everyone to access and review. This allows the Commission to have time to fully consider input and request follow up if needed prior to the meeting.
- V. ADMINISTRATIVE BUSINESS:
  - a) National Police Week proclamation
- VI. CONSENT AGENDA: The items on the Consent Agenda are considered by staff to be routine business items. Approval of the items may be made by a single motion, seconded, and a majority vote with no separate discussion of any item listed. Should a member of the Governing Body desire to discuss any item, it will be removed from the Consent Agenda and considered separately.
  - a) Approval of the minutes of the meeting of April 30, 2025
  - b) Approval of the schedule for the week of May 12, 2025
  - c) Approval of the check register
  - d) Approve and sign the OCB's

VII. FORMAL BOARD ACTION:

- a) Consider a motion to approve Resolution 2025-16, adoption of the Countywide Multi-jurisdictional Hazard Mitigation Plan Region L.
- b) Consider a motion to approve Resolution 2025-17, altering the boundaries of Rural Fire District No. 1 of Leavenworth County, Kansas to remove High Prairie Township which will result in Fire District No. 1 having no remaining territory within its jurisdiction.
- c) Board Order 2025-5, accepting a petition for the attachment of certain property to Rural Water District No. 7 of Leavenworth County, Kansas.
  - **Open Public Hearing**
  - **Close Public Hearing**
  - **Consider a motion to approve Board Order 2025-5, accepting a petition for the attachment of certain property to Rural Water District No. 7 per the legal description provided.**
- d) Consider a motion to approve an agreement that terminates the lease at 711 Marshall St., Leavenworth, Kansas.

VIII. PRESENTATIONS AND DISCUSSION ITEMS: presentations are materials of general concern where no action or vote is requested or anticipated.

IX. ADJOURNMENT

# LEAVENWORTH COUNTY COMMISSIONERS MEETING SCHEDULE

**Monday, May 5, 2025**

**Tuesday, May 6, 2025**

**Wednesday, May 7, 2025**

9:00 a.m.      Leavenworth County Commission meeting  
• Commission Meeting Room, 300 Walnut, Leavenworth KS

**Thursday, May 8, 2025**

12:00 p.m.      LCDC meeting

**Friday, May 9, 2025**

ALL SUCH OTHER BUSINESS THAT MAY COME BEFORE THE COMMISSION

ALL MEETINGS ARE OPEN TO THE PUBLIC

COMMENTS SHOULD BE OF GENERAL INTEREST OF THE PUBLIC AND SUBJECT TO THE RULES OF DECORUM

**PROCLAMATION**  
**National Police Week**  
**May 11<sup>th</sup> – 17<sup>th</sup>, 2025**

To all Citizens of Leavenworth County,

To recognize National Police Week 2025 and to honor the service and sacrifice of those law enforcement officers killed in the line of duty while protecting our communities and safeguarding our democracy.

**Whereas**, there are more than 800,000 law enforcement officers serving in the communities across the United States including the dedicated members of the Leavenworth County Sheriff's Office; and

**Whereas**, since the first recorded death in 1786, there are currently more than 24,000 law enforcement officers in the United States, who have made the ultimate sacrifice and been killed in the line of duty, including four members of the Leavenworth County Sheriff's Office; and

**Whereas**, the dedicated men and women who have chosen law enforcement as a career often face unknown or extraordinary risks and dangers in preserving our freedom and security, and

**Whereas**, these women and men are mothers and fathers, sisters and brothers, daughters and sons, and we give gratitude to their families for supporting them in their careers, and

**Whereas**, we wish to give everyone an opportunity to appreciate and thank the men and women of the Leavenworth County Sheriff's Office who dedicate their lives to public service.

**Whereas**, May 15 is designated as Peace Officers Memorial Day in honor of all fallen officers and their families, and U.S. flags should be flown at half-staff;

**Now, therefore**, be it resolved that we, the Leavenworth County Board of County Commissioners, do hereby proclaim May 11 – 17, 2025, to be:

**National Police Week**

in Leavenworth County and urge all citizens to participate fully in this observance.

In Witness Whereof, I have hereunto set my hand and affixed the seal of Leavenworth County this 7<sup>th</sup> day of May 2025, in Leavenworth County, Kansas.

---

Michael Smith, Chairman  
Leavenworth County Commission



\*\*\*\*\*April 30, 2025 \*\*\*\*\*

The Board of County Commissioners met in a regular session on Wednesday, April 30, 2025. Commissioner Smith, Commissioner Culbertson; Commissioner Stieben, Commissioner Reid and Commissioner Dove are present; Also present: Mark Loughry, County Administrator; Misty Brown, County Counselor; Jon Khalil, Deputy County Counselor; Connie Harmon, Council on Aging Director; Bob Weber, County Appraiser, David Martin, Information Systems Deputy Director

Commissioner Smith read a proclamation recognizing May as Mental Health Awareness Month.

**PUBLIC COMMENT:**

Lynn Looney, Mike Trapp and Joan Murnane commented.

**ADMINISTRATIVE BUSINESS:**

Commissioner Stieben requested approval of Public Works mowing before the Fair.

It was the consensus of the Board to direct Public Works to mow before the Fair.

Commissioner Stieben commented the Board is still getting calls and emails regarding the smell at the Easton landfill.

Commissioner Stieben reported that there are minors receiving services through the Health Department that are chemical in nature and inquired if there are side effects from the medications what is the liability of the County.

Misty Brown stated that any medication that is distributed through the Health Department is done through a doctor from KU and liability discussion should be discussed in an executive session.

Commissioner Culbertson requested a formal motion to add paving 187<sup>th</sup> St from Santa Fe to Logan to the CIP.

***A motion was made by Commissioner Smith and seconded by Commissioner Stieben to add paving 187<sup>th</sup> St from Santa Fe to Logan to the CIP.***

Dennis Bixby commented.

***Motion passed, 5-0.***

***A motion was made by Commissioner Culbertson and seconded by Commissioner Dove to accept the consent agenda for Wednesday, April 30, 2025 as presented.***

***Motion passed, 5-0.***

Commissioner Smith read a letter recognizing Eagle Scout Henry Chaar.

Misty Brown presented Resolution 2025-15, altering the boundaries of Rural Fire District No. 1.

***A motion was made by Commissioner Stieben and seconded by Commissioner Dove to approve Resolution 2025-15, altering the boundaries of Rural Fire District No. 1 of Leavenworth County, Kansas to include only High Prairie Township.***

***Motion passed, 5-0.***

Connie Harmon requested approval of the changes to the Council on Aging Advisory Board by-laws.

***A motion was made by Commissioner Stieben and seconded by Commissioner Culbertson to approve the proposed changes to the Council on Aging Advisory Board by-laws.***

***Motion passed, 5-0.***

Ms. Harmon presented the quarterly report for Council on Aging.

David Martin presented the quarterly report for Information Systems.

Bob Weber presented the quarterly report for the Appraiser's office.

Paul Cromer commented.

The Board discussed a draft resolution addressing animal cruelty.

Julie Downes and Joan Murnane commented.

It was the consensus of the Board to bring back the resolution for approval.

***A motion was made by Commissioner Dove and seconded by Commissioner Smith that the Board recess for a closed executive meeting to consult with our attorneys and discuss confidential matters related to potential claims and litigation which would be deemed privileged in the attorney-client relationship as permitted under the Kansas Open Meetings Act and that the Board resume open meeting at 11:00 a.m. in the meeting room of the Board. Present in the executive meeting will be Commissioners Mike Smith, Jeff Culbertson, Vanessa Reid, Willie Dove, Mike Stieben, County Administrator Mark Loughry, County Counselor Misty Brown and Deputy County Counselor Jon Khalil.***

***Motion passed, 5-0.***

The Board returned to regular session at 11:00 a.m. No action was taken and no decisions were made. The subject was limited to the legal interests of the County.

Commissioner Smith met with Senator Klemp.

***A motion was made by Commissioner Stieben and seconded by Commissioner Dove to adjourn.***

***Motion passed, 5-0.***

The Board adjourned at 11:01 a.m.

# **LEAVENWORTH COUNTY COMMISSIONERS MEETING SCHEDULE**

**Monday, May 12, 2025**

**Tuesday, May 13, 2025**

**Wednesday, May 14, 2025**

9:00 a.m.      Leavenworth County Commission meeting  
• Commission Meeting Room, 300 Walnut, Leavenworth KS

**Thursday, May 15, 2025**

**Friday, May 16, 2025**

ALL SUCH OTHER BUSINESS THAT MAY COME BEFORE THE COMMISSION

ALL MEETINGS ARE OPEN TO THE PUBLIC

COMMENTS SHOULD BE OF GENERAL INTEREST OF THE PUBLIC AND SUBJECT TO THE RULES OF DECORUM

FMWARRPTR2		LEAVENWORTH COUNTY						4/30/25	14:23:30
DCOX		WARRANT REGISTER - BY FUND / VENDOR						Page 1	
		START DATE: 04/26/2025    END DATE: 04/30/2025							
TYPES OF CHECKS SELECTED: * ALL TYPES									
			P.O.NUMBER	CHECK#					
4120	ACE IMAGEWEAR	AAA LAUNDRY & LINEN SUPPLY CO	348463	113494 AP	04/30/2025	5-001-5-53-215	NOX WEED UNIFORMS 4013-01994	104.25	
4120	ACE IMAGEWEAR	AAA LAUNDRY & LINEN SUPPLY CO	348463	113494 AP	04/30/2025	5-001-5-53-215	NOX WEED UNIFORMS 4013-01994	101.33	
4120	ACE IMAGEWEAR	AAA LAUNDRY & LINEN SUPPLY CO	348463	113494 AP	04/30/2025	5-001-5-53-215	NOX WEED UNIFORMS 4013-01994	101.33	
							*** VENDOR	4120 TOTAL	306.91
20588	ADVANTAGE	ADVANTAGE PRINTING	348464	113495 AP	04/30/2025	5-001-5-19-301	98 DIST CT OFFICE SUPPLIES	476.00	
282	AITKENS	AITKENS CONTRACTING LLC	348465	113496 AP	04/30/2025	5-001-5-31-290	COURTHOUSE IRRIGATION TURN ON/	249.00	
917	BECK MECH	WILLIAM BECK	348467	113498 AP	04/30/2025	5-001-5-31-290	CTHSE, CUSHING PIPING/INSULATI	458.34	
917	BECK MECH	WILLIAM BECK	348467	113498 AP	04/30/2025	5-001-5-33-209	CTHSE, CUSHING PIPING/INSULATI	368.00	
							*** VENDOR	917 TOTAL	826.34
4136	BRANDT FAB	BRANDT FABRICATING	348468	113499 AP	04/30/2025	5-001-5-31-320	04-03 MOUNT TOOL BOXES	1,391.40	
648	COMMERCE BANK-COMMER	COMMERCE BANK-COMMERCIAL CARDS	348452	528	04/28/2025	5-001-5-01-202	BOCC:KCCA CONF,LV CITY, LCDCLU	257.50	
648	COMMERCE BANK-COMMER	COMMERCE BANK-COMMERCIAL CARDS	348452	528	04/28/2025	5-001-5-01-205	BOCC:KCCA CONF,LV CITY, LCDCLU	60.00	
648	COMMERCE BANK-COMMER	COMMERCE BANK-COMMERCIAL CARDS	348452	528	04/28/2025	5-001-5-01-212	BOCC:KCCA CONF,LV CITY, LCDCLU	22.13	
648	COMMERCE BANK-COMMER	COMMERCE BANK-COMMERCIAL CARDS	348452	528	04/28/2025	5-001-5-01-213	BOCC:ML:CXL HOTEL MS KCCA MANH	1,092.00-	
648	COMMERCE BANK-COMMER	COMMERCE BANK-COMMERCIAL CARDS	348452	528	04/28/2025	5-001-5-02-202	CLERK/ELECTION:FK:TVL,SUPPLY,T	329.60	
648	COMMERCE BANK-COMMER	COMMERCE BANK-COMMERCIAL CARDS	348452	528	04/28/2025	5-001-5-02-211	CLERK/ELECTION:FK:TVL,SUPPLY,T	760.45	
648	COMMERCE BANK-COMMER	COMMERCE BANK-COMMERCIAL CARDS	348452	528	04/28/2025	5-001-5-02-301	CLERK/ELECTION:FK:TVL,SUPPLY,T	122.87	
648	COMMERCE BANK-COMMER	COMMERCE BANK-COMMERCIAL CARDS	348452	528	04/28/2025	5-001-5-02-301	CLERK/ELECTION:SS:ELECTION TNG	270.06	
648	COMMERCE BANK-COMMER	COMMERCE BANK-COMMERCIAL CARDS	348452	528	04/28/2025	5-001-5-03-301	CO TREAS SPECIAL/TREAS ECH:TT:	414.57	
648	COMMERCE BANK-COMMER	COMMERCE BANK-COMMERCIAL CARDS	348452	528	04/28/2025	5-001-5-05-202	EMS:MW:TNG,TNG EQUIP	159.62	
648	COMMERCE BANK-COMMER	COMMERCE BANK-COMMERCIAL CARDS	348452	528	04/28/2025	5-001-5-05-205	EMS CARD:PHONE,UTIL,RED WASTE,	3.60	
648	COMMERCE BANK-COMMER	COMMERCE BANK-COMMERCIAL CARDS	348452	528	04/28/2025	5-001-5-05-209	EMS CARD:PHONE,UTIL,RED WASTE,	55.00	
648	COMMERCE BANK-COMMER	COMMERCE BANK-COMMERCIAL CARDS	348452	528	04/28/2025	5-001-5-05-210	EMS CARD:PHONE,UTIL,RED WASTE,	212.71	
648	COMMERCE BANK-COMMER	COMMERCE BANK-COMMERCIAL CARDS	348452	528	04/28/2025	5-001-5-05-213	EMS CJ:VEH MAINT/BLDG/VEH SUPP	20.00	
648	COMMERCE BANK-COMMER	COMMERCE BANK-COMMERCIAL CARDS	348452	528	04/28/2025	5-001-5-05-215	EMS CARD:PHONE,UTIL,RED WASTE,	239.10	
648	COMMERCE BANK-COMMER	COMMERCE BANK-COMMERCIAL CARDS	348452	528	04/28/2025	5-001-5-05-216	EMS CARD:PHONE,UTIL,RED WASTE,	241.20	
648	COMMERCE BANK-COMMER	COMMERCE BANK-COMMERCIAL CARDS	348452	528	04/28/2025	5-001-5-05-282	EMS CARD:PHONE,UTIL,RED WASTE,	726.62	
648	COMMERCE BANK-COMMER	COMMERCE BANK-COMMERCIAL CARDS	348452	528	04/28/2025	5-001-5-05-286	EMS:MB:MED EQUIP MAINT, FIELD	30.43	
648	COMMERCE BANK-COMMER	COMMERCE BANK-COMMERCIAL CARDS	348452	528	04/28/2025	5-001-5-05-286	EMS CJ:VEH MAINT/BLDG/VEH SUPP	22.21	
648	COMMERCE BANK-COMMER	COMMERCE BANK-COMMERCIAL CARDS	348452	528	04/28/2025	5-001-5-05-301	EMS CJ:VEH MAINT/BLDG/VEH SUPP	14.98	
648	COMMERCE BANK-COMMER	COMMERCE BANK-COMMERCIAL CARDS	348452	528	04/28/2025	5-001-5-05-301	EMS CARD:PHONE,UTIL,RED WASTE,	748.13	
648	COMMERCE BANK-COMMER	COMMERCE BANK-COMMERCIAL CARDS	348452	528	04/28/2025	5-001-5-05-302	EMS CJ:VEH MAINT/BLDG/VEH SUPP	52.17	
648	COMMERCE BANK-COMMER	COMMERCE BANK-COMMERCIAL CARDS	348452	528	04/28/2025	5-001-5-05-306	EMS HF:VEH MAINT SUPPLY	10.45	
648	COMMERCE BANK-COMMER	COMMERCE BANK-COMMERCIAL CARDS	348452	528	04/28/2025	5-001-5-05-306	EMS CJ:VEH MAINT/BLDG/VEH SUPP	190.15	
648	COMMERCE BANK-COMMER	COMMERCE BANK-COMMERCIAL CARDS	348452	528	04/28/2025	5-001-5-05-306	EMS CARD:PHONE,UTIL,RED WASTE,	177.60	
648	COMMERCE BANK-COMMER	COMMERCE BANK-COMMERCIAL CARDS	348452	528	04/28/2025	5-001-5-05-350	EMS CARD:PHONE,UTIL,RED WASTE,	750.58	
648	COMMERCE BANK-COMMER	COMMERCE BANK-COMMERCIAL CARDS	348452	528	04/28/2025	5-001-5-05-380	EMS:MW:TNG,TNG EQUIP	140.87	
648	COMMERCE BANK-COMMER	COMMERCE BANK-COMMERCIAL CARDS	348452	528	04/28/2025	5-001-5-05-381	EMS:MB:MED EQUIP MAINT, FIELD	3.98	
648	COMMERCE BANK-COMMER	COMMERCE BANK-COMMERCIAL CARDS	348452	528	04/28/2025	5-001-5-05-381	EMS CARD:PHONE,UTIL,RED WASTE,	4,613.14	
648	COMMERCE BANK-COMMER	COMMERCE BANK-COMMERCIAL CARDS	348452	528	04/28/2025	5-001-5-05-384	EMS CARD:PHONE,UTIL,RED WASTE,	57.19	
648	COMMERCE BANK-COMMER	COMMERCE BANK-COMMERCIAL CARDS	348452	528	04/28/2025	5-001-5-05-4	EMS CJ:VEH MAINT/BLDG/VEH SUPP	750.52	
648	COMMERCE BANK-COMMER	COMMERCE BANK-COMMERCIAL CARDS	348452	528	04/28/2025	5-001-5-05-4	EMS CARD:PHONE,UTIL,RED WASTE,	1,438.07	
648	COMMERCE BANK-COMMER	COMMERCE BANK-COMMERCIAL CARDS	348549	530	04/30/2025	5-001-5-06-216	AT&T MOBILITY - PLANNING	43.23	
648	COMMERCE BANK-COMMER	COMMERCE BANK-COMMERCIAL CARDS	348549	530	04/30/2025	5-001-5-06-216	AT&T MOBILITY - PLANNING	43.23	
648	COMMERCE BANK-COMMER	COMMERCE BANK-COMMERCIAL CARDS	348452	528	04/28/2025	5-001-5-06-301	PLANNING:DC:OFFICE SUPPLIES	197.48	
648	COMMERCE BANK-COMMER	COMMERCE BANK-COMMERCIAL CARDS	348452	528	04/28/2025	5-001-5-07-202	LVSO:SF,MH,JP,ET:UNIF,VEH,AMMO	550.00	
648	COMMERCE BANK-COMMER	COMMERCE BANK-COMMERCIAL CARDS	348452	528	04/28/2025	5-001-5-07-202	LVSO:SF,MH,JP,ET:UNIF,VEH,AMMO	250.00	
648	COMMERCE BANK-COMMER	COMMERCE BANK-COMMERCIAL CARDS	348452	528	04/28/2025	5-001-5-07-203	LVSO:ZP:COMM OUTREACH, LICENSE	55.00	
648	COMMERCE BANK-COMMER	COMMERCE BANK-COMMERCIAL CARDS	348452	528	04/28/2025	5-001-5-07-203	LVSO:BM:JAIL/OFC SUPPLY,VEH MA	50.00	
648	COMMERCE BANK-COMMER	COMMERCE BANK-COMMERCIAL CARDS	348452	528	04/28/2025	5-001-5-07-208	LVSO JA,AB,BC,FD:JAIL MAIN/EXP	27.00	
648	COMMERCE BANK-COMMER	COMMERCE BANK-COMMERCIAL CARDS	348549	530	04/30/2025	5-001-5-07-210	AT&T LVSO 5018	92.46	
648	COMMERCE BANK-COMMER	COMMERCE BANK-COMMERCIAL CARDS	348452	528	04/28/2025	5-001-5-07-211	LVSO:AD:UNIFORM,OFC SUPPLIES,S	949.90	

TYPES OF CHECKS SELECTED: \* ALL TYPES

				P.O.NUMBER	CHECK#					
648	COMMERCE BANK-COMMER	COMMERCE BANK-COMMER	COMMERCE BANK-COMMERCIAL CARDS	348452	528	04/28/2025	5-001-5-07-211	LVSO:BM:JAIL/OFC SUPPLY,VEH MA	3.58	
648	COMMERCE BANK-COMMER	COMMERCE BANK-COMMER	COMMERCE BANK-COMMERCIAL CARDS	348452	528	04/28/2025	5-001-5-07-213	LVSO:SF,MH,JP,ET:UNIF,VEH,AMMO	12.09	
648	COMMERCE BANK-COMMER	COMMERCE BANK-COMMER	COMMERCE BANK-COMMERCIAL CARDS	348452	528	04/28/2025	5-001-5-07-213	LVSO:BM:JAIL/OFC SUPPLY,VEH MA	83.72	
648	COMMERCE BANK-COMMER	COMMERCE BANK-COMMER	COMMERCE BANK-COMMERCIAL CARDS	348452	528	04/28/2025	5-001-5-07-251	LVSO:BM:JAIL/OFC SUPPLY,VEH MA	27.07	
648	COMMERCE BANK-COMMER	COMMERCE BANK-COMMER	COMMERCE BANK-COMMERCIAL CARDS	348452	528	04/28/2025	5-001-5-07-251	LVSO JA,AB,BC,FD:JAIL MAIN/EXP	45.00	
648	COMMERCE BANK-COMMER	COMMERCE BANK-COMMER	COMMERCE BANK-COMMERCIAL CARDS	348452	528	04/28/2025	5-001-5-07-301	LVSO:AD:UNIFORM,OFC SUPPLIES,S	225.68	
648	COMMERCE BANK-COMMER	COMMERCE BANK-COMMER	COMMERCE BANK-COMMERCIAL CARDS	348452	528	04/28/2025	5-001-5-07-301	LVSO:BM:JAIL/OFC SUPPLY,VEH MA	99.96	
648	COMMERCE BANK-COMMER	COMMERCE BANK-COMMER	COMMERCE BANK-COMMERCIAL CARDS	348452	528	04/28/2025	5-001-5-07-303	LVSO:AD:UNIFORM,OFC SUPPLIES,S	16.75	
648	COMMERCE BANK-COMMER	COMMERCE BANK-COMMER	COMMERCE BANK-COMMERCIAL CARDS	348452	528	04/28/2025	5-001-5-07-350	LVSO:AD:UNIFORM,OFC SUPPLIES,S	60.95	
648	COMMERCE BANK-COMMER	COMMERCE BANK-COMMER	COMMERCE BANK-COMMERCIAL CARDS	348452	528	04/28/2025	5-001-5-07-350	LVSO:SF,MH,JP,ET:UNIF,VEH,AMMO	2,120.00	
648	COMMERCE BANK-COMMER	COMMERCE BANK-COMMER	COMMERCE BANK-COMMERCIAL CARDS	348452	528	04/28/2025	5-001-5-07-354	LVSO:ZP:COMM OUTREACH, LICENSE	132.41	
648	COMMERCE BANK-COMMER	COMMERCE BANK-COMMER	COMMERCE BANK-COMMERCIAL CARDS	348452	528	04/28/2025	5-001-5-07-356	LVSO:SF,MH,JP,ET:UNIF,VEH,AMMO	254.26	
648	COMMERCE BANK-COMMER	COMMERCE BANK-COMMER	COMMERCE BANK-COMMERCIAL CARDS	348452	528	04/28/2025	5-001-5-07-357	LVSO:BM:JAIL/OFC SUPPLY,VEH MA	81.85	
648	COMMERCE BANK-COMMER	COMMERCE BANK-COMMER	COMMERCE BANK-COMMERCIAL CARDS	348452	528	04/28/2025	5-001-5-07-357	LVSO JA,AB,BC,FD:JAIL MAIN/EXP	86.60	
648	COMMERCE BANK-COMMER	COMMERCE BANK-COMMER	COMMERCE BANK-COMMERCIAL CARDS	348452	528	04/28/2025	5-001-5-07-357	LVSO JA,AB,BC,FD:JAIL MAIN/EXP	60.00	
648	COMMERCE BANK-COMMER	COMMERCE BANK-COMMER	COMMERCE BANK-COMMERCIAL CARDS	348452	528	04/28/2025	5-001-5-07-359	LVSO:BM:JAIL/OFC SUPPLY,VEH MA	22.97	
648	COMMERCE BANK-COMMER	COMMERCE BANK-COMMER	COMMERCE BANK-COMMERCIAL CARDS	348452	528	04/28/2025	5-001-5-07-359	LVSO JA,AB,BC,FD:JAIL MAIN/EXP	92.56	
648	COMMERCE BANK-COMMER	COMMERCE BANK-COMMER	COMMERCE BANK-COMMERCIAL CARDS	348452	528	04/28/2025	5-001-5-07-363	LVSO:AD:UNIFORM,OFC SUPPLIES,S	652.36	
648	COMMERCE BANK-COMMER	COMMERCE BANK-COMMER	COMMERCE BANK-COMMERCIAL CARDS	348452	528	04/28/2025	5-001-5-07-363	LVSO:SF,MH,JP,ET:UNIF,VEH,AMMO	354.00	
648	COMMERCE BANK-COMMER	COMMERCE BANK-COMMER	COMMERCE BANK-COMMERCIAL CARDS	348452	528	04/28/2025	5-001-5-11-213	CO ATTY:LF:WITNESS COSTS, OFFI	25.71	
648	COMMERCE BANK-COMMER	COMMERCE BANK-COMMER	COMMERCE BANK-COMMERCIAL CARDS	348452	528	04/28/2025	5-001-5-11-301	CO ATTY:LF:WITNESS COSTS, OFFI	35.98	
648	COMMERCE BANK-COMMER	COMMERCE BANK-COMMER	COMMERCE BANK-COMMERCIAL CARDS	348452	528	04/28/2025	5-001-5-11-301	CO ATTY:LG:OFFICE SUPPLIES	2,351.78	
648	COMMERCE BANK-COMMER	COMMERCE BANK-COMMER	COMMERCE BANK-COMMERCIAL CARDS	348452	528	04/28/2025	5-001-5-14-229	BG,SD#2:SPEC BLDG:HD,MOWING EQ	564.46	
648	COMMERCE BANK-COMMER	COMMERCE BANK-COMMER	COMMERCE BANK-COMMERCIAL CARDS	348452	528	04/28/2025	5-001-5-18-301	IS:LM:CREDIT FOR SALES TAX	56.91	
648	COMMERCE BANK-COMMER	COMMERCE BANK-COMMER	COMMERCE BANK-COMMERCIAL CARDS	348452	528	04/28/2025	5-001-5-19-217	DIST CT:JC:PUBLICATIONS	630.75	
648	COMMERCE BANK-COMMER	COMMERCE BANK-COMMER	COMMERCE BANK-COMMERCIAL CARDS	348452	528	04/28/2025	5-001-5-19-301	DIST CT:SC:OFFICE SUPPLIES	55.66	
648	COMMERCE BANK-COMMER	COMMERCE BANK-COMMER	COMMERCE BANK-COMMERCIAL CARDS	348452	528	04/28/2025	5-001-5-19-301	DIST CT CD:OFFICE SUPPLIES	154.26	
648	COMMERCE BANK-COMMER	COMMERCE BANK-COMMER	COMMERCE BANK-COMMERCIAL CARDS	348452	528	04/28/2025	5-001-5-21-200	HEALTH DEPT:WFD,OFC SUPPL,TNG,	392.10	
648	COMMERCE BANK-COMMER	COMMERCE BANK-COMMER	COMMERCE BANK-COMMERCIAL CARDS	348452	528	04/28/2025	5-001-5-28-223	HR OFFICE SUPPLIES, TEAMS MEET	102.16	
648	COMMERCE BANK-COMMER	COMMERCE BANK-COMMER	COMMERCE BANK-COMMERCIAL CARDS	348452	528	04/28/2025	5-001-5-31-209	BG,SD#2:SPEC BLDG:HD,MOWING EQ	1,701.99	
648	COMMERCE BANK-COMMER	COMMERCE BANK-COMMER	COMMERCE BANK-COMMERCIAL CARDS	348452	528	04/28/2025	5-001-5-31-209	BG:NH:CTHSE, JC BLDG MAIN, EMS	356.00	
648	COMMERCE BANK-COMMER	COMMERCE BANK-COMMER	COMMERCE BANK-COMMERCIAL CARDS	348452	528	04/28/2025	5-001-5-31-290	BG,SD#2:SPEC BLDG:HD,MOWING EQ	4,487.98	
648	COMMERCE BANK-COMMER	COMMERCE BANK-COMMER	COMMERCE BANK-COMMERCIAL CARDS	348452	528	04/28/2025	5-001-5-31-297	BG,SD#2:SPEC BLDG:HD,MOWING EQ	97.00	
648	COMMERCE BANK-COMMER	COMMERCE BANK-COMMER	COMMERCE BANK-COMMERCIAL CARDS	348452	528	04/28/2025	5-001-5-31-298	BG,SD#2:SPEC BLDG:HD,MOWING EQ	200.00	
648	COMMERCE BANK-COMMER	COMMERCE BANK-COMMER	COMMERCE BANK-COMMERCIAL CARDS	348452	528	04/28/2025	5-001-5-31-301	BG,SD#2:SPEC BLDG:HD,MOWING EQ	45.28	
648	COMMERCE BANK-COMMER	COMMERCE BANK-COMMER	COMMERCE BANK-COMMERCIAL CARDS	348452	528	04/28/2025	5-001-5-31-312	BG,SD#2 ZF:TOOLS,EQUIP REPAIR	69.68	
648	COMMERCE BANK-COMMER	COMMERCE BANK-COMMER	COMMERCE BANK-COMMERCIAL CARDS	348452	528	04/28/2025	5-001-5-31-312	BG,SD#2:SPEC BLDG:HD,MOWING EQ	2,243.66	
648	COMMERCE BANK-COMMER	COMMERCE BANK-COMMER	COMMERCE BANK-COMMERCIAL CARDS	348452	528	04/28/2025	5-001-5-31-312	BG:EC:CTHSE,JC SUPPLIES/MATERI	116.37	
648	COMMERCE BANK-COMMER	COMMERCE BANK-COMMER	COMMERCE BANK-COMMERCIAL CARDS	348452	528	04/28/2025	5-001-5-31-312	BG:NH:CTHSE, JC BLDG MAIN, EMS	269.52	
648	COMMERCE BANK-COMMER	COMMERCE BANK-COMMER	COMMERCE BANK-COMMERCIAL CARDS	348452	528	04/28/2025	5-001-5-31-316	BG,SD#2:SPEC BLDG:HD,MOWING EQ	7.59	
648	COMMERCE BANK-COMMER	COMMERCE BANK-COMMER	COMMERCE BANK-COMMERCIAL CARDS	348452	528	04/28/2025	5-001-5-31-317	BG:NH:CTHSE, JC BLDG MAIN, EMS	5.38	
648	COMMERCE BANK-COMMER	COMMERCE BANK-COMMER	COMMERCE BANK-COMMERCIAL CARDS	348452	528	04/28/2025	5-001-5-31-320	BG,SD#2 ZF:TOOLS,EQUIP REPAIR	24.99	
648	COMMERCE BANK-COMMER	COMMERCE BANK-COMMER	COMMERCE BANK-COMMERCIAL CARDS	348452	528	04/28/2025	5-001-5-31-320	BG,SD#2:SPEC BLDG:HD,MOWING EQ	928.18	
648	COMMERCE BANK-COMMER	COMMERCE BANK-COMMER	COMMERCE BANK-COMMERCIAL CARDS	348452	528	04/28/2025	5-001-5-31-320	BG:RT:VEH REPAIR, JC BLDG MAIN	20.66	
648	COMMERCE BANK-COMMER	COMMERCE BANK-COMMER	COMMERCE BANK-COMMERCIAL CARDS	348452	528	04/28/2025	5-001-5-31-322	BG:NH:CTHSE, JC BLDG MAIN, EMS	22.97	
648	COMMERCE BANK-COMMER	COMMERCE BANK-COMMER	COMMERCE BANK-COMMERCIAL CARDS	348452	528	04/28/2025	5-001-5-31-390	BG,SD#2:SPEC BLDG:HD,MOWING EQ	267.24	
648	COMMERCE BANK-COMMER	COMMERCE BANK-COMMER	COMMERCE BANK-COMMERCIAL CARDS	348452	528	04/28/2025	5-001-5-32-296	BG,SD#2:SPEC BLDG:HD,MOWING EQ	992.75	
648	COMMERCE BANK-COMMER	COMMERCE BANK-COMMER	COMMERCE BANK-COMMERCIAL CARDS	348452	528	04/28/2025	5-001-5-32-297	BG,SD#2:SPEC BLDG:HD,MOWING EQ	769.11	
648	COMMERCE BANK-COMMER	COMMERCE BANK-COMMER	COMMERCE BANK-COMMERCIAL CARDS	348452	528	04/28/2025	5-001-5-32-391	BG:EC:CTHSE,JC SUPPLIES/MATERI	50.93	
648	COMMERCE BANK-COMMER	COMMERCE BANK-COMMER	COMMERCE BANK-COMMERCIAL CARDS	348452	528	04/28/2025	5-001-5-32-391	BG:NH:CTHSE, JC BLDG MAIN, EMS	42.80	
648	COMMERCE BANK-COMMER	COMMERCE BANK-COMMER	COMMERCE BANK-COMMERCIAL CARDS	348452	528	04/28/2025	5-001-5-32-391	BG:RT:VEH REPAIR, JC BLDG MAIN	17.01	
648	COMMERCE BANK-COMMER	COMMERCE BANK-COMMER	COMMERCE BANK-COMMERCIAL CARDS	348452	528	04/28/2025	5-001-5-33-209	BG,SD#2:SPEC BLDG:HD,MOWING EQ	7,220.94	

START DATE: 04/26/2025    END DATE: 04/30/2025

TYPES OF CHECKS SELECTED: \* ALL TYPES

			P.O. NUMBER	CHECK#						
648	COMMERCE BANK-COMMER	COMMERCE BANK-COMMERCIAL CARDS	348452	528	04/28/2025	5-001-5-33-297	BG,SD#2:SPEC BLDG:HD,MOWING EQ	392.71		
648	COMMERCE BANK-COMMER	COMMERCE BANK-COMMERCIAL CARDS	348452	528	04/28/2025	5-001-5-33-391	BG,SD#2 ZF:TOOLS,EQUIP REPAIR	692.34		
648	COMMERCE BANK-COMMER	COMMERCE BANK-COMMERCIAL CARDS	348452	528	04/28/2025	5-001-5-33-391	BG,SD#2:SPEC BLDG:HD,MOWING EQ	4,950.00		
648	COMMERCE BANK-COMMER	COMMERCE BANK-COMMERCIAL CARDS	348452	528	04/28/2025	5-001-5-41-201	APPR:WM:TONER,OFIC SUPPLY,COPI	78.73		
648	COMMERCE BANK-COMMER	COMMERCE BANK-COMMERCIAL CARDS	348452	528	04/28/2025	5-001-5-41-211	APPR:WM:TONER,OFIC SUPPLY,COPI	5.48		
648	COMMERCE BANK-COMMER	COMMERCE BANK-COMMERCIAL CARDS	348452	528	04/28/2025	5-001-5-41-301	APPR:WM:TONER,OFIC SUPPLY,COPI	25.96		
648	COMMERCE BANK-COMMER	COMMERCE BANK-COMMERCIAL CARDS	348452	528	04/28/2025	5-001-5-41-371	APPRAISER:OFC CARD - TONER	777.90		
648	COMMERCE BANK-COMMER	COMMERCE BANK-COMMERCIAL CARDS	348452	528	04/28/2025	5-001-5-41-371	APPR:WM:TONER,OFIC SUPPLY,COPI	659.89		
648	COMMERCE BANK-COMMER	COMMERCE BANK-COMMERCIAL CARDS	348452	528	04/28/2025	5-001-5-49-202	CLERK/ELECTION:FK:TVL,SUPPLY,T	20.00		
648	COMMERCE BANK-COMMER	COMMERCE BANK-COMMERCIAL CARDS	348452	528	04/28/2025	5-001-5-49-202	CLERK/ELECTION:SS:ELECTION TNG	110.69		
648	COMMERCE BANK-COMMER	COMMERCE BANK-COMMERCIAL CARDS	348452	528	04/28/2025	5-001-5-49-211	CLERK/ELECTION:SS:ELECTION TNG	39.84		
648	COMMERCE BANK-COMMER	COMMERCE BANK-COMMERCIAL CARDS	348452	528	04/28/2025	5-001-5-49-301	CLERK/ELECTION:SS:ELECTION TNG	42.35		
648	COMMERCE BANK-COMMER	COMMERCE BANK-COMMERCIAL CARDS	348452	528	04/28/2025	5-001-5-49-301	CLERK/ELECTION:SS:ELECTION TNG	58.20		
648	COMMERCE BANK-COMMER	COMMERCE BANK-COMMERCIAL CARDS	348452	528	04/28/2025	5-001-5-53-202	NOX WEED A:LICENSES,FORMS,OFC	225.00		
648	COMMERCE BANK-COMMER	COMMERCE BANK-COMMERCIAL CARDS	348452	528	04/28/2025	5-001-5-53-217	NOX WEED A:LICENSES,FORMS,OFC	59.00		
648	COMMERCE BANK-COMMER	COMMERCE BANK-COMMERCIAL CARDS	348452	528	04/28/2025	5-001-5-53-301	NOX WEED A:LICENSES,FORMS,OFC	361.52		
648	COMMERCE BANK-COMMER	COMMERCE BANK-COMMERCIAL CARDS	348452	528	04/28/2025	5-001-5-53-308	NOX WEED A:LICENSES,FORMS,OFC	193.04		
*** VENDOR								648 TOTAL	51,400.24	
3998	DREXEL TEC	DREXEL TECHNOLOGIES INC	348473	113504 AP	04/30/2025	5-001-5-42-207	26927 SVC CALL - REPL BELT, SE	417.92		
938	ENGHOUSE INTERAVTIVE	ENGHOUSE INTERACTIVE INC	348474	113505 AP	04/30/2025	5-001-5-07-208	160-901B MAINT TO 2.28.26	1,344.95		
8686	EVERGY EFT	EVERGY KANSAS CENTRAL INC	348551	532	04/30/2025	5-001-5-14-220	ELEC SVC COURTHOUSE	7,433.00		
8686	EVERGY EFT	EVERGY KANSAS CENTRAL INC	348551	532	04/30/2025	5-001-5-32-392	ELEC SVC JUSTICE CENTER	18,982.06		
8686	EVERGY EFT	EVERGY KANSAS CENTRAL INC	348551	532	04/30/2025	5-001-5-32-392	ELEC SVC KPL BUILDING	36.62		
8686	EVERGY EFT	EVERGY KANSAS CENTRAL INC	348551	532	04/30/2025	5-001-5-33-392	ELEC SVC CUSHING	5,118.56		
8686	EVERGY EFT	EVERGY KANSAS CENTRAL INC	348551	532	04/30/2025	5-001-5-53-219	ELEC SVC NOX WEED	289.19		
*** VENDOR								8686 TOTAL	31,859.43	
1011	FEDEX	FEDEX	348476	113507 AP	04/30/2025	5-001-5-19-302	2049 3883 4 DIST CT TRANSPORTA	32.46		
894	FORENSIC MEDICAL	FORENSIC MEDICAL MANAGEMENT SE	348480	113511 AP	04/30/2025	5-001-5-13-271	G10CBFM02020015 MAR 2025 AUTOP	75.00		
894	FORENSIC MEDICAL	FORENSIC MEDICAL MANAGEMENT SE	348480	113511 AP	04/30/2025	5-001-5-13-271	G10CBFM02020015 MAR 2025 AUTOP	75.00		
894	FORENSIC MEDICAL	FORENSIC MEDICAL MANAGEMENT SE	348480	113511 AP	04/30/2025	5-001-5-13-271	G10CBFM02020015 MAR 2025 AUTOP	50.00		
894	FORENSIC MEDICAL	FORENSIC MEDICAL MANAGEMENT SE	348480	113511 AP	04/30/2025	5-001-5-13-271	G10CBFM02020015 MAR 2025 AUTOP	2,475.00		
894	FORENSIC MEDICAL	FORENSIC MEDICAL MANAGEMENT SE	348480	113511 AP	04/30/2025	5-001-5-13-271	G10CBFM02020015 MAR 2025 AUTOP	75.00		
894	FORENSIC MEDICAL	FORENSIC MEDICAL MANAGEMENT SE	348480	113511 AP	04/30/2025	5-001-5-13-271	G10CBFM02020015 MAR 2025 AUTOP	2,475.00		
894	FORENSIC MEDICAL	FORENSIC MEDICAL MANAGEMENT SE	348480	113511 AP	04/30/2025	5-001-5-13-271	G10CBFM02020015 MAR 2025 AUTOP	50.00		
894	FORENSIC MEDICAL	FORENSIC MEDICAL MANAGEMENT SE	348480	113511 AP	04/30/2025	5-001-5-13-271	G10CBFM02020015 MAR 2025 AUTOP	75.00		
894	FORENSIC MEDICAL	FORENSIC MEDICAL MANAGEMENT SE	348480	113511 AP	04/30/2025	5-001-5-13-271	G10CBFM02020015 MAR 2025 AUTOP	50.00		
894	FORENSIC MEDICAL	FORENSIC MEDICAL MANAGEMENT SE	348480	113511 AP	04/30/2025	5-001-5-13-271	G10CBFM02020015 MAR 2025 AUTOP	2,475.00		
894	FORENSIC MEDICAL	FORENSIC MEDICAL MANAGEMENT SE	348480	113511 AP	04/30/2025	5-001-5-13-271	G10CBFM02020015 MAR 2025 AUTOP	2,475.00		
894	FORENSIC MEDICAL	FORENSIC MEDICAL MANAGEMENT SE	348480	113511 AP	04/30/2025	5-001-5-13-271	G10CBFM02020015 MAR 2025 AUTOP	50.00		
894	FORENSIC MEDICAL	FORENSIC MEDICAL MANAGEMENT SE	348480	113511 AP	04/30/2025	5-001-5-13-271	G10CBFM02020015 MAR 2025 AUTOP	850.00		
894	FORENSIC MEDICAL	FORENSIC MEDICAL MANAGEMENT SE	348480	113511 AP	04/30/2025	5-001-5-13-271	G10CBFM02020015 MAR 2025 AUTOP	50.00		
894	FORENSIC MEDICAL	FORENSIC MEDICAL MANAGEMENT SE	348480	113511 AP	04/30/2025	5-001-5-13-271	G10CBFM02020015 MAR 2025 AUTOP	2,475.00		
894	FORENSIC MEDICAL	FORENSIC MEDICAL MANAGEMENT SE	348480	113511 AP	04/30/2025	5-001-5-13-271	G10CBFM02020015 MAR 2025 AUTOP	2,475.00		
894	FORENSIC MEDICAL	FORENSIC MEDICAL MANAGEMENT SE	348480	113511 AP	04/30/2025	5-001-5-13-271	G10CBFM02020015 MAR 2025 AUTOP	50.00		
894	FORENSIC MEDICAL	FORENSIC MEDICAL MANAGEMENT SE	348480	113511 AP	04/30/2025	5-001-5-13-271	G10CBFM02020015 MAR 2025 AUTOP	2,475.00		
894	FORENSIC MEDICAL	FORENSIC MEDICAL MANAGEMENT SE	348480	113511 AP	04/30/2025	5-001-5-13-271	G10CBFM02020015 MAR 2025 AUTOP	2,475.00		
894	FORENSIC MEDICAL	FORENSIC MEDICAL MANAGEMENT SE	348480	113511 AP	04/30/2025	5-001-5-13-271	G10CBFM02020015 MAR 2025 AUTOP	50.00		
894	FORENSIC MEDICAL	FORENSIC MEDICAL MANAGEMENT SE	348480	113511 AP	04/30/2025	5-001-5-13-271	G10CBFM02020015 MAR 2025 AUTOP	2,475.00		
894	FORENSIC MEDICAL	FORENSIC MEDICAL MANAGEMENT SE	348480	113511 AP	04/30/2025	5-001-5-13-271	G10CBFM02020015 MAR 2025 AUTOP	2,475.00		
894	FORENSIC MEDICAL	FORENSIC MEDICAL MANAGEMENT SE	348480	113511 AP	04/30/2025	5-001-5-13-271	G10CBFM02020015 MAR 2025 AUTOP	50.00		
894	FORENSIC MEDICAL	FORENSIC MEDICAL MANAGEMENT SE	348480	113511 AP	04/30/2025	5-001-5-13-271	G10CBFM02020015 MAR 2025 AUTOP	850.00		
894	FORENSIC MEDICAL	FORENSIC MEDICAL MANAGEMENT SE	348480	113511 AP	04/30/2025	5-001-5-13-271	G10CBFM02020015 MAR 2025 AUTOP	2,475.00		
894	FORENSIC MEDICAL	FORENSIC MEDICAL MANAGEMENT SE	348480	113511 AP	04/30/2025	5-001-5-13-271	G10CBFM02020015 MAR 2025 AUTOP	2,475.00		
894	FORENSIC MEDICAL	FORENSIC MEDICAL MANAGEMENT SE	348480	113511 AP	04/30/2025	5-001-5-13-271	G10CBFM02020015 MAR 2025 AUTOP	2,475.00		

warrants by vendor

TYPES OF CHECKS SELECTED: \* ALL TYPES

P.O.NUMBER      CHECK#

99    JUROR

\*\*\* VENDOR      894 TOTAL      29,625.00

warrants by vendor

FMWARRPTR2		LEAVENWORTH COUNTY							4/30/25	14:23:30
DCOX		WARRANT REGISTER - BY FUND / VENDOR							Page	5
		START DATE: 04/26/2025    END DATE: 04/30/2025								
TYPES OF CHECKS SELECTED: * ALL TYPES										
				P.O.NUMBER	CHECK#					
99	JUROR									
		*** VENDOR							99 TOTAL	2,494.80
9737	KS ROD	KANSAS REGISTER OF DEEDS ASSN	348524	113555 AP	04/30/2025	5-001-5-04-202	SEMINAR REGISTRATION	250.00		
28529	LEADSONLINE LLC	LEADSONLINE LLC	348526	113557 AP	04/30/2025	5-001-5-07-208	AGENCY ID 74 12 MO MAINT/SUPPO	5,815.00		
975	LEAV LANSI	LEAVENWORTH/LANSING CHAMBER	348528	113559 AP	04/30/2025	5-001-5-01-203	ANNUAL MEMBERSHIP DUES	1,430.00		
2059	MIDWEST OFFICE TECH	MIDWEST OFFICE TECHNOLOGY INC	348531	113562 AP	04/30/2025	5-001-5-07-219	LC00_K COPIES CONTRACT/OVERAGE	55.00		
2059	MIDWEST OFFICE TECH	MIDWEST OFFICE TECHNOLOGY INC	348531	113562 AP	04/30/2025	5-001-5-07-219	LC00_K COPIES CONTRACT/OVERAGE	1.26		
2059	MIDWEST OFFICE TECH	MIDWEST OFFICE TECHNOLOGY INC	348531	113562 AP	04/30/2025	5-001-5-11-303	CO ATTY COPIES OPL305_K	66.82		
		*** VENDOR							2059 TOTAL	123.08
7098	QUILL CORP	QUILL CORP	348535	113566 AP	04/30/2025	5-001-5-04-301	3309088 VOID STAMP - ROD	13.29		
13413	REPUBLIC	ALLIED SERVICES	348537	113568 AP	04/30/2025	5-001-5-07-208	3-0468-0124688 TRASH SRVICE	355.27		
8350	SECURITAS TECHNOLOGY	SECURITAS TECHNOLOGY COPRORATI	348538	113569 AP	04/30/2025	5-001-5-07-359	10700928 SHERIFF - REMOTE SUPP	162.00		
42020	SMITH MICHAEL COMM	COMMISSIONER MIKE SMITH	348539	113570 AP	04/30/2025	5-001-5-01-205	REIM MILEAGE FOR KCCA CONF - M	173.60		
684	VERITIV CORPORATION	VERITIV CORPORATION	348543	113574 AP	04/30/2025	5-001-5-07-359	165151 SHF - JAIL SUPPLIES	804.24		
276	WEX	WEX BANK	348548	529	04/30/2025	5-001-5-11-253	CO ATTY FUEL TO 4.23	59.88		
276	WEX	WEX BANK	348548	529	04/30/2025	5-001-5-14-331	EMS FUEL TO 4/23	6,530.16		
276	WEX	WEX BANK	348548	529	04/30/2025	5-001-5-14-333	BG FUEL TO 4.23	15.89		
		*** VENDOR							276 TOTAL	6,605.93
100	WITNESS LIST									
		*** VENDOR							100 TOTAL	87.18
		TOTAL FUND 001							136,244.04	
-----										
648	COMMERCE BANK-COMMER	COMMERCE BANK-COMMERCIAL CARDS	348452	528	04/28/2025	5-108-5-00-202	HEALTH DEPT:WFD,OFC SUPPL,TNG,	153.60		
648	COMMERCE BANK-COMMER	COMMERCE BANK-COMMERCIAL CARDS	348452	528	04/28/2025	5-108-5-00-213	HEALTH DEPT:WFD,OFC SUPPL,TNG,	70.00		
648	COMMERCE BANK-COMMER	COMMERCE BANK-COMMERCIAL CARDS	348452	528	04/28/2025	5-108-5-00-219	HEALTH DEPT:WFD,OFC SUPPL,TNG,	429.14		
648	COMMERCE BANK-COMMER	COMMERCE BANK-COMMERCIAL CARDS	348452	528	04/28/2025	5-108-5-00-280	HEALTH DEPT:WFD,OFC SUPPL,TNG,	761.50		
648	COMMERCE BANK-COMMER	COMMERCE BANK-COMMERCIAL CARDS	348452	528	04/28/2025	5-108-5-00-301	HEALTH DEPT:WFD,OFC SUPPL,TNG,	1,700.38		
648	COMMERCE BANK-COMMER	COMMERCE BANK-COMMERCIAL CARDS	348452	528	04/28/2025	5-108-5-00-302	HEALTH DEPT:WFD,OFC SUPPL,TNG,	16.59		
648	COMMERCE BANK-COMMER	COMMERCE BANK-COMMERCIAL CARDS	348452	528	04/28/2025	5-108-5-00-384	HEALTH DEPT:WFD,OFC SUPPL,TNG,	1,596.98		
648	COMMERCE BANK-COMMER	COMMERCE BANK-COMMERCIAL CARDS	348452	528	04/28/2025	5-108-5-00-601	HEALTH DEPT:WFD,OFC SUPPL,TNG,	800.63		
648	COMMERCE BANK-COMMER	COMMERCE BANK-COMMERCIAL CARDS	348452	528	04/28/2025	5-108-5-00-606	HEALTH DEPT WIC JH	642.00		
648	COMMERCE BANK-COMMER	COMMERCE BANK-COMMERCIAL CARDS	348452	528	04/28/2025	5-108-5-00-606	HEALTH DEPT:WFD,OFC SUPPL,TNG,	373.14		
648	COMMERCE BANK-COMMER	COMMERCE BANK-COMMERCIAL CARDS	348452	528	04/28/2025	5-108-5-00-610	HEALTH DEPT:WFD,OFC SUPPL,TNG,	30.81		
		*** VENDOR							648 TOTAL	6,574.77
2900	HEALTH/EMS OVERPAY	PATIENT	348481	113512 AP	04/30/2025	5-108-5-00-280	HEALTH DEPT REFUND	10.15		
8466	KDHE PERMITS	KDHE STD SECTION/INFERTILITY P	348523	113554 AP	04/30/2025	5-108-5-00-380	MEDICAL SUPPLIES	37.50		
8466	KDHE PERMITS	KDHE STD SECTION/INFERTILITY P	348523	113554 AP	04/30/2025	5-108-5-00-380	MEDICAL SUPPLIES	37.50		
8466	KDHE PERMITS	KDHE STD SECTION/INFERTILITY P	348523	113554 AP	04/30/2025	5-108-5-00-380	MEDICAL SUPPLIES	37.50		
8466	KDHE PERMITS	KDHE STD SECTION/INFERTILITY P	348523	113554 AP	04/30/2025	5-108-5-00-380	MEDICAL SUPPLIES	37.50		
		*** VENDOR							8466 TOTAL	150.00
		TOTAL FUND 108							6,734.92	
-----										
648	COMMERCE BANK-COMMER	COMMERCE BANK-COMMERCIAL CARDS	348452	528	04/28/2025	5-117-5-00-202	CLERK/ELECTION:FK:TVL,SUPPLY,T	329.60		
		TOTAL FUND 117							329.60	

warrants by vendor



START DATE: 04/26/2025    END DATE: 04/30/2025

			P.O.NUMBER	CHECK#						
648	COMMERCE BANK-COMMER	COMMERCE BANK-COMMERCIAL CARDS	348452	528	04/28/2025	5-118-5-00-301	CO TREAS SPECIAL/TREAS ECH:TT:	24.99	24.99	
TOTAL FUND 118										
543	HEARTLAND RADAC	HEARTLAND REGIONAL ALCOHOL AND	348482	113513 AP	04/30/2025	5-123-5-00-210	CLIENT ASSESSMENT	200.00	200.00	
TOTAL FUND 123										
276	WEX	WEX BANK	348548	529	04/30/2025	5-125-5-00-211	COMM CORR FUEL TO 4.23	52.31	52.31	
TOTAL FUND 125										
648	COMMERCE BANK-COMMER	COMMERCE BANK-COMMERCIAL CARDS	348452	528	04/28/2025	5-126-5-00-221	COMM CORR RB:TOLLS, POSTAGE, S	4.56		
648	COMMERCE BANK-COMMER	COMMERCE BANK-COMMERCIAL CARDS	348452	528	04/28/2025	5-126-5-00-321	COMM CORR RB:TOLLS, POSTAGE, S	40.69		
*** VENDOR 648 TOTAL									45.25	
7098	QUILL CORP	QUILL CORP	348535	113566 AP	04/30/2025	5-126-5-00-321	5645204 COMM CORR OFFICE SUPPL	116.25		
TOTAL FUND 126									161.50	
648	COMMERCE BANK-COMMER	COMMERCE BANK-COMMERCIAL CARDS	348452	528	04/28/2025	5-127-5-00-3	COMM CORR SH	200.00		
648	COMMERCE BANK-COMMER	COMMERCE BANK-COMMERCIAL CARDS	348452	528	04/28/2025	5-127-5-00-3	COMM CORR JV	123.82		
648	COMMERCE BANK-COMMER	COMMERCE BANK-COMMERCIAL CARDS	348452	528	04/28/2025	5-127-5-00-3	COMM CORR MI CLIENT INCENTIVES	100.00		
648	COMMERCE BANK-COMMER	COMMERCE BANK-COMMERCIAL CARDS	348452	528	04/28/2025	5-127-5-00-3	COMM CORR CS:BIRTH CERT FOR CL	14.00		
648	COMMERCE BANK-COMMER	COMMERCE BANK-COMMERCIAL CARDS	348452	528	04/28/2025	5-127-5-00-3	COMM CORR RB:TOLLS, POSTAGE, S	254.21		
*** VENDOR 648 TOTAL									692.03	
2505	INTRINSIC INTERVENTI	INTRINSIC INTERVENTIONS	348487	113518 AP	04/30/2025	5-127-5-00-3	LAB COSTS	25.00		
2505	INTRINSIC INTERVENTI	INTRINSIC INTERVENTIONS	348487	113518 AP	04/30/2025	5-127-5-00-3	LAB COSTS	25.00		
2505	INTRINSIC INTERVENTI	INTRINSIC INTERVENTIONS	348487	113518 AP	04/30/2025	5-127-5-00-3	LAB COSTS	25.00		
2505	INTRINSIC INTERVENTI	INTRINSIC INTERVENTIONS	348487	113518 AP	04/30/2025	5-127-5-00-3	LAB COSTS	25.00		
*** VENDOR 2505 TOTAL									100.00	
276	WEX	WEX BANK	348548	529	04/30/2025	5-127-5-00-3	COMM CORR FUEL TO 4.23	29.13		
TOTAL FUND 127									821.16	
4120	ACE IMAGEWEAR	AAA LAUNDRY & LINEN SUPPLY CO	348463	113494 AP	04/30/2025	5-133-5-00-215	4-61 4013-01993 UNIFORM RENTAL	348.05		
4120	ACE IMAGEWEAR	AAA LAUNDRY & LINEN SUPPLY CO	348463	113494 AP	04/30/2025	5-133-5-00-215	4-61 4013-01993 UNIFORM RENTAL	303.33		
4120	ACE IMAGEWEAR	AAA LAUNDRY & LINEN SUPPLY CO	348463	113494 AP	04/30/2025	5-133-5-00-215	4-61 4013-01993 UNIFORM RENTAL	365.96		
4120	ACE IMAGEWEAR	AAA LAUNDRY & LINEN SUPPLY CO	348463	113494 AP	04/30/2025	5-133-5-00-312	4-61 4013-01993 UNIFORM RENTAL	276.39		
4120	ACE IMAGEWEAR	AAA LAUNDRY & LINEN SUPPLY CO	348463	113494 AP	04/30/2025	5-133-5-00-312	4-61 4013-01993 UNIFORM RENTAL	235.96		
4120	ACE IMAGEWEAR	AAA LAUNDRY & LINEN SUPPLY CO	348463	113494 AP	04/30/2025	5-133-5-00-312	4-61 4013-01993 UNIFORM RENTAL	238.37		
*** VENDOR 4120 TOTAL									1,768.06	
3026	ASP ENTERPRISES	A.S.P. ENTERPRISES, INC	348466	113497 AP	04/30/2025	5-133-5-00-325	4-62 104244 EROSION CONTROL	1,480.00		
4605	C & H OUTDOOR	C & H OUTDOOR LLC	348469	113500 AP	04/30/2025	5-133-5-00-360	4-76 SCREEN FOR BRINE	1,567.00		
2509	CENTRAL SALT, LLC	CENTRAL SALT, LLC	348470	113501 AP	04/30/2025	5-133-5-00-306	4-64 C00404 BULK DEICING SALT	1,554.81		
2509	CENTRAL SALT, LLC	CENTRAL SALT, LLC	348470	113501 AP	04/30/2025	5-133-5-00-306	4-64 C00404 BULK DEICING SALT	1,552.48		
2509	CENTRAL SALT, LLC	CENTRAL SALT, LLC	348470	113501 AP	04/30/2025	5-133-5-00-306	4-64 C00404 BULK DEICING SALT	1,533.82		
2509	CENTRAL SALT, LLC	CENTRAL SALT, LLC	348470	113501 AP	04/30/2025	5-133-5-00-306	4-64 C00404 BULK DEICING SALT	3,080.46		
2509	CENTRAL SALT, LLC	CENTRAL SALT, LLC	348470	113501 AP	04/30/2025	5-133-5-00-306	4-64 C00404 BULK DEICING SALT	1,546.06		
2509	CENTRAL SALT, LLC	CENTRAL SALT, LLC	348470	113501 AP	04/30/2025	5-133-5-00-306	4-64 C00404 BULK DEICING SALT	1,546.65		
*** VENDOR 2509 TOTAL									10,814.28	
648	COMMERCE BANK-COMMER	COMMERCE BANK-COMMERCIAL CARDS	348452	528	04/28/2025	4-133-5-00-365	4-57 PUB WORKS AA,TE,TOOLS, PA	260.00		
648	COMMERCE BANK-COMMER	COMMERCE BANK-COMMERCIAL CARDS	348452	528	04/28/2025	5-133-5-00-201	4-60 PUB WORKS JW,PW:PHONE,OFC	524.99		
648	COMMERCE BANK-COMMER	COMMERCE BANK-COMMERCIAL CARDS	348452	528	04/28/2025	5-133-5-00-203	4-58 PW:ZE,FG,VG,GH:SAFETY,TOO	36.75		
648	COMMERCE BANK-COMMER	COMMERCE BANK-COMMERCIAL CARDS	348452	528	04/28/2025	5-133-5-00-208	4-60 PUB WORKS JW,PW:PHONE,OFC	26.91		
648	COMMERCE BANK-COMMER	COMMERCE BANK-COMMERCIAL CARDS	348452	528	04/28/2025	5-133-5-00-209	4-60 PUB WORKS JW,PW:PHONE,OFC	63.50		
648	COMMERCE BANK-COMMER	COMMERCE BANK-COMMERCIAL CARDS	348452	528	04/28/2025	5-133-5-00-210	4-60 PUB WORKS JW,PW:PHONE,OFC	1,248.53		

warrants by vendor

START DATE: 04/26/2025    END DATE: 04/30/2025

warrants by vendor

START DATE: 04/26/2025    END DATE: 04/30/2025

warrants by vendor

FMWARRPTR2		LEAVENWORTH COUNTY							4/30/25	14:23:30
DCOX		WARRANT REGISTER - BY FUND / VENDOR							Page 9	
		START DATE: 04/26/2025    END DATE: 04/30/2025								
TYPES OF CHECKS SELECTED: * ALL TYPES										
		P.O.NUMBER		CHECK#						
648	COMMERCE BANK-COMMER	COMMERCE BANK-COMMERCIAL CARDS	348452	528	04/28/2025	5-145-5-00-210	CO ON AGING - BACKGROUND CK,L&	30.00		
648	COMMERCE BANK-COMMER	COMMERCE BANK-COMMERCIAL CARDS	348452	528	04/28/2025	5-145-5-00-210	CO ON AGING DO:BACKGROUND CKS,	180.00		
648	COMMERCE BANK-COMMER	COMMERCE BANK-COMMERCIAL CARDS	348452	528	04/28/2025	5-145-5-00-212	COA & PALS:CC:PET SUPPLIES, MI	49.99		
648	COMMERCE BANK-COMMER	COMMERCE BANK-COMMERCIAL CARDS	348452	528	04/28/2025	5-145-5-00-213	COA DT:VEH MAINT & EQUIP	187.99		
648	COMMERCE BANK-COMMER	COMMERCE BANK-COMMERCIAL CARDS	348452	528	04/28/2025	5-145-5-00-252	CO ON AGING - TH:MEETINGS, LEI	51.96		
648	COMMERCE BANK-COMMER	COMMERCE BANK-COMMERCIAL CARDS	348452	528	04/28/2025	5-145-5-00-252	COA & MEMORIAL, CH:PET SUPPLIE	93.81		
648	COMMERCE BANK-COMMER	COMMERCE BANK-COMMERCIAL CARDS	348452	528	04/28/2025	5-145-5-00-253	CO ON AGING - BACKGROUND CK,L&	103.52		
648	COMMERCE BANK-COMMER	COMMERCE BANK-COMMERCIAL CARDS	348452	528	04/28/2025	5-145-5-00-253	CO ON AGING DO:BACKGROUND CKS,	14.98		
648	COMMERCE BANK-COMMER	COMMERCE BANK-COMMERCIAL CARDS	348452	528	04/28/2025	5-145-5-00-254	CO ON AGING RK:L&L,JANITORIAL,	123.53		
648	COMMERCE BANK-COMMER	COMMERCE BANK-COMMERCIAL CARDS	348452	528	04/28/2025	5-145-5-00-254	COA JP:PROGRAM CONTINGENCIES	186.73		
648	COMMERCE BANK-COMMER	COMMERCE BANK-COMMERCIAL CARDS	348452	528	04/28/2025	5-145-5-00-255	CO ON AGING RK:L&L,JANITORIAL,	15.79		
648	COMMERCE BANK-COMMER	COMMERCE BANK-COMMERCIAL CARDS	348452	528	04/28/2025	5-145-5-00-303	CO ON AGING - BACKGROUND CK,L&	447.56		
648	COMMERCE BANK-COMMER	COMMERCE BANK-COMMERCIAL CARDS	348452	528	04/28/2025	5-145-5-00-306	CO ON AGING - BACKGROUND CK,L&	44.97		
648	COMMERCE BANK-COMMER	COMMERCE BANK-COMMERCIAL CARDS	348452	528	04/28/2025	5-145-5-00-306	COA DT:VEH MAINT & EQUIP	87.12		
648	COMMERCE BANK-COMMER	COMMERCE BANK-COMMERCIAL CARDS	348452	528	04/28/2025	5-145-5-00-746	CO ON AGING DO:BACKGROUND CKS,	300.00		
648	COMMERCE BANK-COMMER	COMMERCE BANK-COMMERCIAL CARDS	348452	528	04/28/2025	5-145-5-00-750	CO ON AGING - BACKGROUND CK,L&	484.58		
648	COMMERCE BANK-COMMER	COMMERCE BANK-COMMERCIAL CARDS	348452	528	04/28/2025	5-145-5-00-750	CO ON AGING - TH:MEETINGS, LEI	235.80		
648	COMMERCE BANK-COMMER	COMMERCE BANK-COMMERCIAL CARDS	348452	528	04/28/2025	5-145-5-00-750	CO ON AGING RK:L&L,JANITORIAL,	643.76		
648	COMMERCE BANK-COMMER	COMMERCE BANK-COMMERCIAL CARDS	348452	528	04/28/2025	5-145-5-00-750	CO ON AGING TP:LEISURE & LEARN	176.61		
*** VENDOR 648 TOTAL								3,458.70		
4755	LEAV PAPER	LEAVENWORTH PAPER AND OFFICE S	348529	113560 AP	04/30/2025	5-145-5-00-345	CO ON AGING THINK YOU BAGS	29.57		
4755	LEAV PAPER	LEAVENWORTH PAPER AND OFFICE S	348529	113560 AP	04/30/2025	5-145-5-00-345	CO ON AGING THINK YOU BAGS	58.57		
4755	LEAV PAPER	LEAVENWORTH PAPER AND OFFICE S	348529	113560 AP	04/30/2025	5-145-5-05-301	CO ON AGING THINK YOU BAGS	12.62		
4755	LEAV PAPER	LEAVENWORTH PAPER AND OFFICE S	348529	113560 AP	04/30/2025	5-145-5-06-301	CO ON AGING THINK YOU BAGS	9.59		
4755	LEAV PAPER	LEAVENWORTH PAPER AND OFFICE S	348529	113560 AP	04/30/2025	5-145-5-06-321	CO ON AGING THINK YOU BAGS	31.95		
4755	LEAV PAPER	LEAVENWORTH PAPER AND OFFICE S	348529	113560 AP	04/30/2025	5-145-5-07-302	CO ON AGING THINK YOU BAGS	1.31		
4755	LEAV PAPER	LEAVENWORTH PAPER AND OFFICE S	348529	113560 AP	04/30/2025	5-145-5-07-321	CO ON AGING THINK YOU BAGS	6.39		
*** VENDOR 4755 TOTAL								150.00		
276	WEX	WEX BANK	348548	529	04/30/2025	5-145-5-00-304	CO ON AGING FUEL TO 4.23	4,074.87		
TOTAL FUND 145								7,683.57		
648	COMMERCE BANK-COMMER	COMMERCE BANK-COMMERCIAL CARDS	348452	528	04/28/2025	5-146-5-00-301	CO TREAS SPECIAL:AH:OFFICE SUP	439.07		
TOTAL FUND 146								439.07		
648	COMMERCE BANK-COMMER	COMMERCE BANK-COMMERCIAL CARDS	348452	528	04/28/2025	5-147-5-00-3	COA & MEMORIAL, CH:PET SUPPLIE	109.99		
TOTAL FUND 147								109.99		
648	COMMERCE BANK-COMMER	COMMERCE BANK-COMMERCIAL CARDS	348452	528	04/28/2025	5-160-5-00-208	SOLID WASTE:TS:HHW,OFC SUPPLY,	384.17		
648	COMMERCE BANK-COMMER	COMMERCE BANK-COMMERCIAL CARDS	348452	528	04/28/2025	5-160-5-00-213	SOLID WASTE:JA: PPE, FUEL/LUBE	866.03		
648	COMMERCE BANK-COMMER	COMMERCE BANK-COMMERCIAL CARDS	348452	528	04/28/2025	5-160-5-00-301	SOLID WASTE:TS:HHW,OFC SUPPLY,	1,020.43		
648	COMMERCE BANK-COMMER	COMMERCE BANK-COMMERCIAL CARDS	348452	528	04/28/2025	5-160-5-00-304	SOLID WASTE:JA: PPE, FUEL/LUBE	148.33		
648	COMMERCE BANK-COMMER	COMMERCE BANK-COMMERCIAL CARDS	348452	528	04/28/2025	5-160-5-00-305	SOLID WASTE:TS:HHW,OFC SUPPLY,	342.32		
648	COMMERCE BANK-COMMER	COMMERCE BANK-COMMERCIAL CARDS	348452	528	04/28/2025	5-160-5-00-305	SOLID WASTE:JA: PPE, FUEL/LUBE	170.58		
*** VENDOR 648 TOTAL								2,931.86		
8686	EVERGY EFT	EVERGY KANSAS CENTRAL INC	348551	532	04/30/2025	5-160-5-00-210	ELEC SVC SOLID WASTE TRANSFER	316.32		
8686	EVERGY EFT	EVERGY KANSAS CENTRAL INC	348551	532	04/30/2025	5-160-5-00-210	ELEC SVC SOLID WASTE TRANSFER	31.44		
8686	EVERGY EFT	EVERGY KANSAS CENTRAL INC	348551	532	04/30/2025	5-160-5-00-210	ELEC SVC SOLID WASTE TRANSFER	220.34		
*** VENDOR 8686 TOTAL								568.10		
2007	WIRENUTS	WIRENUTS	348544	113575 AP	04/30/2025	5-160-5-00-213	SOLID WASTE - ADD TRNASMITTERS	292.50		
2007	WIRENUTS	WIRENUTS	348544	113575 AP	04/30/2025	5-160-5-00-304	SOLID WASTE FUEL TO 4.23	23.81		
*** VENDOR 2007 TOTAL								316.31		
warrants by vendor										

FMWARRPTR2		LEAVENWORTH COUNTY						4/30/25	14:23:30
DCOX		WARRANT REGISTER - BY FUND / VENDOR						Page	10
		START DATE: 04/26/2025    END DATE: 04/30/2025							
TYPES OF CHECKS SELECTED: * ALL TYPES									
		P.O.NUMBER	CHECK#						
		TOTAL FUND 160							3,816.27
648	COMMERCE BANK-COMMER	COMMERCE BANK-COMMERCIAL CARDS	348452	528	04/28/2025	5-194-5-00-3	LVSO:AD:UNIFORM,OFC SUPPLIES,S	520.00	
		TOTAL FUND 194							520.00
8686	EVERGY EFT	EVERGY KANSAS CENTRAL INC	348551	532	04/30/2025	5-195-5-00-290	ELEC SVC COMM CORR	435.13	
		TOTAL FUND 195							435.13
648	COMMERCE BANK-COMMER	COMMERCE BANK-COMMERCIAL CARDS	348452	528	04/28/2025	5-198-5-18-201	EMPG - SUPPLIES FOR COUNTY FAI	1,979.98	
		TOTAL FUND 198							1,979.98
648	COMMERCE BANK-COMMER	COMMERCE BANK-COMMERCIAL CARDS	348452	528	04/28/2025	5-212-5-00-2	BG,SD#2:SPEC BLDG:HD,MOWING EQ	73.75	
648	COMMERCE BANK-COMMER	COMMERCE BANK-COMMERCIAL CARDS	348452	528	04/28/2025	5-212-5-00-3	BG,SD#2 ZF:TOOLS,EQUIP REPAIR	16.99	
		*** VENDOR 648 TOTAL							90.74
		TOTAL FUND 212							90.74
508	DELTA	DELTA INNOVATIVE SERVICES,INC	348472	113503 AP	04/30/2025	5-215-5-14-401	24-0084 CTHSE ROOF REPL SVC TO	15,534.54	
		TOTAL FUND 215							15,534.54
8661	KANSAS SECURED-LV	KANSAS SECURED TITLE - LEAVENW	348522	113553 AP	04/30/2025	5-220-5-02-400	4-3 O&E REPORTS PARR/MASON	425.00	
8661	KANSAS SECURED-LV	KANSAS SECURED TITLE - LEAVENW	348522	113553 AP	04/30/2025	5-220-5-02-400	4-3 O&E REPORTS PARR/MASON	425.00	
		*** VENDOR 8661 TOTAL							850.00
		TOTAL FUND 220							850.00
537	LEAV TIMES	CHERRYROAD MEDIA INC	348458	1012 AP	04/29/2025	5-222-5-00-201	30360 FIRE DIST NO 1 PUB OF RE	154.00	
		TOTAL FUND 222							154.00
		TOTAL ALL CHECKS							297,959.62

FUND SUMMARY

001	GENERAL	136,244.04
108	COUNTY HEALTH	6,734.92
117	CO CLERK TECHNOLOGY	329.60
118	TREASURER TECH FUND	24.99
123	JUVENILE CRIME PREVENTION	200.00
125	CPJJ	52.31
126	COMM CORR ADULT	161.50
127	COMM CORR ADULT NON GRANT	821.16
133	ROAD & BRIDGE	110,500.66
135	COMM CORR OPIOID	34.77
136	COMM CORR JUVENILE	192.20
137	LOCAL SERVICE ROAD & BRIDGE	9,890.25
138	JUV INTAKE & ASSESSMENT	142.46
144	PALS (PETS AND LOVING SENIORS	1,017.47
145	COUNCIL ON AGING	7,683.57
146	COUNTY TREASURER SPECIAL	439.07
147	MEMORIALS (COA)	109.99
160	SOLID WASTE MANAGEMENT	3,816.27
194	VIOLENT OFFENDERS	520.00
195	JUVENILE DETENTION	435.13
198	SPECIAL GRANTS	1,979.98
212	SEWER DISTRICT 2:   TIMBERLAKES	90.74
215	CAPITAL IMPROVEMENTS	15,534.54
220	CAP IMPR: RD & BRIDGE	850.00
222	BOCC FIRE MGMT	154.00
	TOTAL ALL FUNDS	297,959.62

# CONSENT AGENDA 5-7-2025

# Leavenworth County Request for Board Action

Date: 5/7/2025

To: Board of County Commissioners

From: Emergency Management

Department Head Approval: Charles Magallon on behalf of the Sheriff.

## Additional Reviews as needed:

Budget Review ☐ Administrator Review ☐ Legal Review ☐

---

---

**Action Requested:** Leavenworth County Board of County Commissioners adopt the resolution accepting the Hazard Mitigation Plan for region L, Johnson, Wyandotte and Leavenworth Counties.

**Recommendation:** Adopt the resolution and place into effect the Mitigation Plan with ability to apply for Mitigation Grants to protect citizens in Leavenworth County. No fiscal impact will be incurred by adopting the plan, however if Mitigation grants are sought a 25% share of a local match would be required either in a soft in kind match or a hard funding match 75% funded by the Federal Emergency Management Agency.

**Analysis:** Emergency Management the State of Kansas has held many meetings with the jurisdictions in Leavenworth County for the purpose of developing an all hazard mitigation plan that fits the needs of Leavenworth County. This comprehensive plan has addressed mitigation efforts within the County to lessen the impact from disasters or emergencies resulting from natural disasters, accidental, or man-caused events. This plan is a multi-county plan to include Johnson, Leavenworth and Wyandotte counties know as by the State of Kansas Region L. The Mitigation Plan has been prepared in accordance with FEMA requirements at 44 CFR 201.6 and has been accepted and reviewed by FEMA after the County and all Jurisdictions that are named in the Plan sign adoption of a resolution for their jurisdictions. Once this signing of a resolution has been completed, Leavenworth County jurisdictions may apply for Mitigation grants through the State of Kansas.

**Alternatives:** By not adopting the Mitigation Plan as reviewed by FEMA would cause the forfeit any chance to regain grant funding through FEMA in regards to Mitigation efforts to protect Leavenworth County Citizens for all municipalities listed in the plan.

## **Budgetary Impact:**

- xx Not Applicable  
☐ Budgeted item with available funds  
☐ Non-Budgeted item with available funds through prioritization  
☐ Non-Budgeted item with additional funds requested

**Total Amount Requested:**

**Additional Attachments:**

### Leavenworth County and Participating Jurisdictions Mitigation Actions

Action Identification	Description	Hazard Addressed	Responsible Party	Overall Priority	Goal(s) Addressed	Estimated Cost	Potential Funding Source	Proposed Completion Timeframe	Current Status
Leavenworth County-1	Identify the county's most at-risk critical facilities and evaluate potential mitigation techniques for protecting each facility to the maximum extent possible.	All Hazards	Emergency Manager	Medium	1,2	Staff Time	Jurisdiction budget	Five years	
Leavenworth County-2	Conduct an inventory/survey for the county's emergency response services to identify any existing needs or shortfalls in terms of personnel, equipment or required resources.	All Hazards	Emergency Manager	Medium	1	Staff Time	Jurisdiction budget	Five years	
Leavenworth County-3	Develop cross-departmental information collection capabilities and incorporate cadastral (building/parcel) data utilizing a GIS for purposes of conducting more detailed hazard risk assessments and for tracking permitting / land use patterns, buildings and infrastructure replacement costs, and overall structural accounting for the county.	All Hazards	Emergency Manager	Medium	4	Staff Time	Jurisdiction budget	Five years	
Leavenworth County-4	Research and recommend appropriate building codes for the jurisdiction that includes wind resistant design techniques for new construction.	All Hazards	Emergency Manager	High	1,4	Staff Time	Jurisdiction budget	Five years	
Leavenworth County-5	The Leavenworth Water Department will continue to assess the impact of natural hazards on water distribution lines, systems, and equipment. The Department will also seek additional Funding sources to mitigate damage to critical infrastructure.	All Hazards	Water Department Director	Medium	1,2	Staff Time and Project Dependent	HMGP, BRIC, Jurisdiction budget	Five years	
Leavenworth County-6	Collect educational materials on individual and family preparedness / mitigation measures for property owners, and display at both the library and routinely visited	All Hazards	Emergency Manager	High	3	Staff Time	Jurisdiction budget	Continuous	



### Leavenworth County and Participating Jurisdictions Mitigation Actions

Action Identification	Description	Hazard Addressed	Responsible Party	Overall Priority	Goal(s) Addressed	Estimated Cost	Potential Funding Source	Proposed Completion Timeframe	Current Status
Leavenworth County-7	Annually host a public “hazards workshop” in combination with local festivals, fairs, or other appropriate events.	All Hazards	Emergency Manager	High	3,4	Staff Time	Jurisdiction budget	Continuous	
Leavenworth County-8	Establish, promote, and fund continuity of water systems between rural water districts to larger water departments to manage future growth in the county.	All Hazards	Emergency Manager	Medium	4	Staff Time	Jurisdiction budget	Five years	
Leavenworth County-9	Prepare and adopt an Outdoor Warning Sirens Plan for the county, including consideration of the unique geographical locations, technical requirements, system types and operational procedures of each local jurisdiction.	All Hazards	Emergency Manager	Medium	1,2	Staff Time	Jurisdiction budget	Five years	
Leavenworth County-10	Develop an annex to the Local Emergency Operations Plan (LEOP) for dam/levee failure response and evacuation plans for high hazard dams/levees in Leavenworth County.	Dam/Levee	Emergency Manager	High	1,2	Staff Time	Jurisdiction budget	Five years	
Leavenworth County-11	Research and contact all owners of high hazard dams in the county and inform them of their responsibility to provide Emergency Action Plans to the Leavenworth County Emergency Management. Additionally, Levee owners should be contacted regarding potential PM 43 requirements for continued validation of protected areas behind the levees.	Dam/Levee Failure	Emergency Manager	High	3,4	Staff Time	Jurisdiction budget	Continuous	
Leavenworth County-12	Conduct debris removal in Big Stranger Creek that is located within the Drainage District.	Dam/Levee, Flood	Big Strange Drainage District Director	Medium	1,2	\$200,000	HMGP, Jurisdiction budget	Five years	
Leavenworth County-13	NFIP - Identify levee owners in the jurisdiction.	Flood	Planner, Emergency	High		Staff Time	Jurisdiction budget	Five years	

### Leavenworth County and Participating Jurisdictions Mitigation Actions

Action Identification	Description	Hazard Addressed	Responsible Party	Overall Priority	Goal(s) Addressed	Estimated Cost	Potential Funding Source	Proposed Completion Timeframe	Current Status
			Manager, Levee District Directors						
Leavenworth County-14	Mail updated information to all agricultural producers concerning emerging threats.	Agricultural Infestation	Emergency Manager	High	1, 2	Staff Time and \$500	Jurisdiction budget	Five years	New
Leavenworth County-15	Conduct agricultural education program on water reduction methods.	Agricultural Infestation, Drought	Emergency Manager	High	1, 3	Staff Time	Jurisdiction budget	Five years	New
Leavenworth County-16	Revise building codes to require low water flow toilets and faucets.	Drought	Administrator	High	1, 2	Staff Time	Jurisdiction budget	Five years	New
Leavenworth County-17	Conduct a native, low water planting program for all jurisdictional owned facilities	Drought	Facilities Director	Low	1, 2	\$5,000 - \$50,000 per location	HMGP, BRIC, Jurisdiction budget	Five years	New
Leavenworth County-18	Modernization HVAC systems in jurisdictional facilities.	Extreme Temperatures	Facilities Director	Low	1, 2	\$25,000 per facility	HMGP, BRIC, Jurisdiction budget	Ten years	New
Leavenworth County-19	Identify and prepare county building for usage as heat/cold shelters.	Extreme Temperatures	Facilities Director	Low	1, 2	\$2,000 per facility	Jurisdiction budget	Ten years	New
Leavenworth County-20	Continued operation and management of jurisdictional NFIP activities.	Flood	Floodplain Manager	High	1,2	Staff Time	Jurisdiction budget	Continuous	
Leavenworth County-21	NFIP - Acquire and demolish or preserve parcels of land subject to repetitive flooding from willing and voluntary property owners.	Flood	Emergency Management Planner	High	1,2	Size and location dependent	HMGP, BRIC, FMA, Jurisdiction budget	Five years	
Leavenworth County-22	NFIP - Regularly calculate and document the amount of flood prone property that is preserved as open space to reduce flood insurance burden to the county.	Flood	Planner, Flood Plain Administrator	High	1,2	Staff Time	Jurisdiction budget	Continuous	
Leavenworth County-23	NFIP - Identify flash-flood prone areas to consider flood reduction measures to county planners.	Flood	Planner	High	1,2	Staff Time	Jurisdiction budget	Continuous	

### Leavenworth County and Participating Jurisdictions Mitigation Actions

Action Identification	Description	Hazard Addressed	Responsible Party	Overall Priority	Goal(s) Addressed	Estimated Cost	Potential Funding Source	Proposed Completion Timeframe	Current Status
Leavenworth County-24	NFIP - Amend the Floodplain Management Ordinance to include a “no-rise (in base flood elevation)” clause for Leavenworth County.	Flood	Planning Commission, Planner	High	1,2	Staff Time	Jurisdiction budget	Five years	
Leavenworth County-25	NFIP - Research and design an appropriate stream buffer ordinance to further protect the jurisdiction’s water resources and to limit future flood damages adjacent to major waterways.	Flood	Planning Commission, Planner	High		Staff Time	Jurisdiction budget	Five years	
Leavenworth County-26	NFIP - Implement a study to determine the residual flood risk in levee-protected areas.	Flood	Planner, Levee Districts	Medium					
Leavenworth County-27	NFIP - Seek Funding to complete a stormwater drainage study for Leavenworth County that will lead to a stormwater management ordinance that maintains pre-development runoff rates.	Flood	Planner, Public Works	Medium	1,2	\$100,000	HMGP, BRIC, Jurisdiction budget	Five years	
Leavenworth County-28	NFIP - Contact owners identified in high-risk flood areas and inform them of potential availability of assistance through the FEMA program, in addition to other flood protection measures.	Flood	County Planners, City Officials	High	3	Staff Time	Jurisdiction budget	Continuous	
Leavenworth County-29	NFIP - Advertise and promote the availability of flood insurance to property owners by direct mail once a year.	Flood	County Planners, City Officials	High	3	Staff Time	Jurisdiction budget	Continuous	
Leavenworth County-30	NFIP - The County and local governments will work with the Kansas Dept. of Ag - Division of Water Resources to educate and promote local jurisdictional participation in the NFIP CRS.	Flood	Emergency Management, City Officials	High	3	Staff Time	Jurisdiction budget	Continuous	

### Leavenworth County and Participating Jurisdictions Mitigation Actions

Action Identification	Description	Hazard Addressed	Responsible Party	Overall Priority	Goal(s) Addressed	Estimated Cost	Potential Funding Source	Proposed Completion Timeframe	Current Status
Leavenworth County-31	Design and construct safe rooms in all future buildings built by the County.	Severe Weather, Tornado	Facilities Director	High	1,2	Project size dependent	HMGP, BRIC, Jurisdiction budget	Five years	New
Leavenworth County-32	Fund the construction of safe rooms and storm shelters in public and private schools, day care centers and senior care facilities.	Severe Weather, Tornado	Facilities Director	High	1,2	Project size dependent	HMGP, BRIC, Jurisdiction budget	Five years	
Leavenworth County-33	Research, develop, and recommend an ordinance/resolution to require installation of tornado shelters for major manufactured and/or mobile home parks with more than 10 mobile home spaces.	Severe Weather, Tornado	Facilities Director	High	1,2	Staff Time	Jurisdiction budget	Five years	
Leavenworth County-34	Install hail, wind, and fire resistant roofing on all jurisdictional facilities.	Severe Weather, Tornado, Wildfire	Facilities Director	Medium	1, 2	\$50,000 per location	HMGP, BRIC, Jurisdiction budget	Five years	New
Leavenworth County-35	Educate residents about driving in winter storms and handling winter-related health effects.	Severe Winter Storm	Director of Emergency Management	High	3,4	Staff Time	Jurisdiction budget	Repeating	New
Leavenworth County-36	Evaluate the firefighting water supply resources within the County.	Wildfire	Fire Chiefs, Director of Emergency Management	Medium	1,2	Staff Time	Jurisdiction budget	Repeating	
Leavenworth County-37	Create defensible space buffers at all critical facilities	Wildfire	Fire Chiefs, Director of Emergency Management	High	1,2	Facility size dependent	HMGP, BRIC, Jurisdiction budget	As required	New
Leavenworth County-38	Develop and implement a wildfire prevention/education program.	Wildfire	Fire Chiefs, Director of Emergency Management	Medium	3,4	\$1,200 per year	Jurisdiction budget	Repeating	
Leavenworth County-39	Examine the current agreements within the county and assess the need	Wildfire	Fire Chiefs, Director of	High	4	Staff Time	Jurisdiction budget	Repeating	

### Leavenworth County and Participating Jurisdictions Mitigation Actions

Action Identification	Description	Hazard Addressed	Responsible Party	Overall Priority	Goal(s) Addressed	Estimated Cost	Potential Funding Source	Proposed Completion Timeframe	Current Status
	to expand or update cooperative agreements for firefighting resources.		Emergency Management						
Leavenworth County-40	Appoint a rural fire committee to schedule meetings with the Kansas Forest Service to map suspected hazardous wildfire areas in the county for potential participation in the Community Wildfire Protection Program (CWPP).	Wildfire	Fire Chiefs, Director of Emergency Management	Medium	3,4	Staff Time	Jurisdiction budget	Four Years	
Leavenworth County-41	Incorporate wildfire maps, develop actions and projects for wildfire prevention, and complete an assessment report to meet CWPP requirements for submittal to the Kansas Forest Service.	Wildfire	Fire Chiefs, Director of Emergency Management	Medium	1,4	Staff Time	Jurisdiction budget	Four Years	
Leavenworth County-42	Purchase cloud storage backup for all jurisdictional electronic records.	Cybersecurity Incident	IT Director	High	1, 2	Data size dependent	Jurisdiction budget	Five years	New
Leavenworth County-43	Provide hazardous materials management classes to all county employees handling hazardous materials.	Hazardous Materials Event	Emergency Manager	High	1, 2	\$500 per trainee	HMGP, Jurisdiction budget	As required	New
Leavenworth County-44	The Leavenworth County Consolidated Rural Water District (RWD) No. 1 will continue to assess the impact of natural hazards on water distribution lines, systems, and equipment. The Water District will also seek Funding sources to mitigate damage to critical infrastructure and seek Funding for various water main improvement projects.	Infrastructure Failure	Director	Medium	1,2	Staff Time	Jurisdiction budget	Continuous	
Leavenworth County-45	Coordinate county and local government mitigation efforts with Rural Electric Cooperatives (REC's), encourage identification of hazards potentially affecting their infrastructure, assessment of the	Infrastructure Failure	Emergency Manager, Rural Electric Cooperative Directors	Medium	1,2,4	Staff Time	Jurisdiction budget	Continuous	

### Leavenworth County and Participating Jurisdictions Mitigation Actions

Action Identification	Description	Hazard Addressed	Responsible Party	Overall Priority	Goal(s) Addressed	Estimated Cost	Potential Funding Source	Proposed Completion Timeframe	Current Status
	vulnerabilities of the infrastructure to these hazards, and identification of mitigation strategies.								
Leavenworth County-46	The Leavenworth County Rural Water District (RWD) No. 7 will continue to assess the impact of natural hazards on water distribution lines, systems, and equipment. The Water District will also seek Funding sources to mitigate damage to critical infrastructure and seek Funding for various water main improvement projects.	Infrastructure Failure	Director	Medium	1,2	Staff Time	Jurisdiction budget	Continuous	
Leavenworth County-47	Obtain Funding for the purchase of mobile backup power generators for the groundwater well facilities of Leavenworth County Rural Water District (RWD) 7.	Infrastructure Failure	Director	Medium	1,2	\$100,000	HMGP, BRIC, Jurisdiction budget	Five years	
Leavenworth County-48	Promote and educate the jurisdiction's public and private sectors on potential agricultural terrorism and bio-terrorism issues that can severely impact the county and regional economies and develop and implement plans to address these issues.	Terrorism	Emergency Manager	High	1,2,3,4	Staff Time	Jurisdiction budget	Continuous	
Leavenworth County-49	Conduct active shooter drills and exercises for all county personnel.	Terrorism	County Sheriff	Low	1, 2	Data size dependent	Jurisdiction budget	Five years	New
Leavenworth County-50	Purchase and install new epidemiological tracking software.	Transmissible Disease	Health Department Director	High	1, 2	\$500 per trainee	HMGP, Local budgets	As required	New
Basehor-1	Purchase and install critical facility backup generators.	All hazards	City Superintendent	High	1, 2	\$25,000 - \$50,000 per facility	HMGP, BRIC, Jurisdiction budget	Five years	Carried over due to lack of funding

### Leavenworth County and Participating Jurisdictions Mitigation Actions

Action Identification	Description	Hazard Addressed	Responsible Party	Overall Priority	Goal(s) Addressed	Estimated Cost	Potential Funding Source	Proposed Completion Timeframe	Current Status
Basehor-2	Develop a radio communications plan between the City of Basehor Public Works Department / Street Department and City Hall to ensure interoperability between entities.	All hazards	City Superintendent	High	1, 2	Staff Time	Jurisdiction budget	Five years	
Basehor-3	Purchase of equipment to assist in the removal of debris and assist with cleanups after major storms.	All Hazards	City Superintendent	High	1,2	\$400,000	HMGP, Jurisdiction budget	Five years	
Basehor-4	Install evacuation route signage in any high hazard dam or levee failure inundation areas.	Dam/Levee Failure	City Superintendent	Medium	1, 2, 4	\$5,000 per location	HMGP, Jurisdiction budget	Five years	New
Basehor-5	Conduct a native, low water planting program for all jurisdictional owned facilities	Drought	City Superintendent	Medium	1, 2	\$5,000 - \$20,000 per facility	HMGP, BRIC, Jurisdiction budget	Ten years	New
Basehor-6	Identify and prepare local facilities to serve as heating/cooling centers.	Extreme Temperatures	City Superintendent	Medium	1, 2	\$3,000 per facility	HMGP, Jurisdiction budget	Five years	New
Basehor-7	Continue to participate meet requirements of the NFIP.	Flood	NFIP Coordinator	High	1, 2	Staff time	Jurisdiction budget	Continuous	On-going
Basehor-8	Construct rainwater retention/detention ponds or other flood control projects at strategic locations.	Flood	City Superintendent	Low	1, 2	Location and size dependent	HMGP, BRIC, Jurisdiction budget	As required	
Basehor-9	Clean and repair drainage ditches to maintain capacity.	Flood	City Superintendent	Low	1, 2	Location, length, and size dependent	HMGP, BRIC, Jurisdiction budget	Ten years	New
Basehor-10	Install hail and fire-resistant roofing on all jurisdictional facilities.	Severe Weather, Wildfires	City Superintendent	Low	1, 2	\$50,000 per location	HMGP, BRIC, Jurisdiction budget	Five years	New
Basehor-11	Purchase a brine applicator and mixer to apply chemicals to roads within the City of Basehor prior to	Severe Winter Weather	City Superintendent	Low	4	\$200,000	HMGP, Jurisdiction budget	Five years	

### Leavenworth County and Participating Jurisdictions Mitigation Actions

Action Identification	Description	Hazard Addressed	Responsible Party	Overall Priority	Goal(s) Addressed	Estimated Cost	Potential Funding Source	Proposed Completion Timeframe	Current Status
	major winter storm events, including ice storms.								
Basehor-12	Construct community saferooms in select jurisdictional buildings.	Tornado	City Superintendent	High	1, 2	Facility size dependent	HMGP, BRIC, Jurisdiction budget	Ten years	
Basehor-13	Create defensible space buffers at all critical facilities	Wildfire	Fire Chief	High	1, 2	Facility size dependent	HMGP, BRIC, Jurisdiction budget	As required	New
Easton-1	Purchase and install critical facility backup generators.	All hazards	City Manager	High	1, 2	\$25,000 - \$50,000 per facility	HMGP, BRIC, Jurisdiction budget	Five years	
Easton-2	Install evacuation route and high ground signage in any high hazard dam or levee failure potential inundation areas.	Dam/Levee Failure	City Manager	Medium	1, 2, 4	\$5,000 per location	HMGP, Jurisdiction budget	Five years	New
Easton-3	Conduct a xeriscaping program for all jurisdictional owned facilities	Drought	City Manager	Medium	1, 2	\$5,000 - \$20,000 per facility	HMGP, BRIC, Jurisdiction budget	Ten years	New
Easton-4	Conduct a personal water use education program.	Drought	City Manager	Low	3	Staff time	HMGP, BRIC, Jurisdiction budget	Five years	New
Easton-5	Identify and prepare local facilities to serve as heating/cooling centers.	Extreme Temperatures	City Manager	Medium	1, 2	\$3,000 per facility	HMGP, Jurisdiction budget	Five years	New
Easton-6	Continue to participate meet requirements of the NFIP.	Flood	NFIP Coordinator	High	1, 2	Staff time	Jurisdiction budget	Continuous	On-going
Easton-7	Construct rainwater retention/detention ponds or other flood control projects at strategic locations.	Flood	City Manager	High	1, 2	Location and size dependent	HMGP, BRIC, Jurisdiction budget	As required	



### Leavenworth County and Participating Jurisdictions Mitigation Actions

Action Identification	Description	Hazard Addressed	Responsible Party	Overall Priority	Goal(s) Addressed	Estimated Cost	Potential Funding Source	Proposed Completion Timeframe	Current Status
Easton-8	Seek funding to raise the casings around the potable water wells utilized by the City of Easton to protect them from flood water contamination.	Flood	City Manager	Medium	1, 2	Location, length, and size dependent	HMGP, BRIC, Jurisdiction budget	Five years	
Easton-9	Purchase and install control valves for the City of Easton Water Treatment Plant and storage facility in the event of flooding events.	Flood	City Manager	Medium	1, 2	\$150,000	HMGP, BRIC, Jurisdiction budget	Five years	
Easton-10	Conduct an engineering study and complete the project to raise the State highway 300 yards east of First Street to the twin bridges over Stranger Creek.	Flood	City Manager	Medium	1, 2	\$50,000	HMGP, BRIC, Jurisdiction budget	Five years	
Easton-11	Construct community saferooms in select jurisdictional buildings.	Severe Weather, Tornado Wildfires	City Manager	Low	1,2	Staff Time	Local, State, Federal	Repeating	
Easton-12	Install hail and fire-resistant roofing on all jurisdictional facilities.	Severe Weather, Wildfires	City Manager	Low	1, 2	\$50,000 per location	Facility size dependent	Five years	New
Easton-13	Conduct public education program for driving in winter conditions.	Severe Winter Weather	City Manager	Low	4	Staff Time	Jurisdiction budget	Five years	New
Easton-14	Create defensible space buffers at all critical facilities	Wildfire	Fire Chief	High	1, 2	Facility size dependent	HMGP, BRIC, Jurisdiction budget	As required	New
Lansing-1	Purchase and install critical facility backup generators.	All hazards	City Manager	High	1, 2	\$25,000 - \$50,000 per facility	HMGP, BRIC, Jurisdiction budget	Five years	
Lansing-2	Install evacuation route signage in any high hazard dam or levee failure inundation areas.	Dam/Levee Failure	City Superintendent	Medium	1, 2, 4	\$5,000 per location	HMGP, Jurisdiction budget	Five years	New
Lansing-3	Conduct a native, low water planting program for all jurisdictional owned facilities	Drought	City Superintendent	Medium	1, 2	\$5,000 - \$20,000 per facility	HMGP, BRIC,	Ten years	New

### Leavenworth County and Participating Jurisdictions Mitigation Actions

Action Identification	Description	Hazard Addressed	Responsible Party	Overall Priority	Goal(s) Addressed	Estimated Cost	Potential Funding Source	Proposed Completion Timeframe	Current Status
							Jurisdiction budget		
Lansing-4	Identify and prepare local facilities to serve as heating/cooling centers.	Extreme Temperatures	City Superintendent	Medium	1, 2	\$3,000 per facility	HMGP, Jurisdiction budget	Five years	New
Lansing-5	Continue to participate meet requirements of the NFIP.	Flood	NFIP Coordinator	High	1, 2	Staff time	Jurisdiction budget	Continuous	On-going
Lansing-6	Construct rainwater retention/detention ponds or other flood control projects at strategic locations.	Flood	City Superintendent	Low	1, 2	Location and size dependent	HMGP, BRIC, Jurisdiction budget	As required	
Lansing-7	Clean and repair drainage ditches to maintain capacity.	Flood	City Superintendent	Low	1, 2	Location, length, and size dependent	HMGP, BRIC, Jurisdiction budget	Ten years	New
Lansing-8	Install hail and fire-resistant roofing on all jurisdictional facilities.	Severe Weather, Wildfires	City Superintendent	Low	1, 2	\$50,000 per location	HMGP, BRIC, Jurisdiction budget	Five years	New
Lansing-9	Conduct public education program for driving in winter conditions.	Severe Winter Weather	City Superintendent	Low	4	Staff Time	Jurisdiction budget	Five years	
Lansing-10	Construct community saferooms in select jurisdictional buildings.	Tornado	City Superintendent	High	1, 2	Facility size dependent	HMGP, BRIC, Jurisdiction budget	Ten years	
Lansing-11	Create defensible space buffers at all critical facilities	Wildfire	Fire Chief	High	1, 2	Facility size dependent	HMGP, BRIC, Jurisdiction budget	As required	New
Lansing-12	Construct community saferooms in select jurisdictional buildings and in mobile home parks currently without a shelter.	Tornado	City Manager	High	1, 2	Facility size dependent	HMGP, BRIC, Jurisdiction budget	Ten years	
Lansing-13	Create defensible space buffers at all critical facilities	Wildfire	Fire Chief	High	1, 2	Facility size dependent	HMGP, BRIC,	As required	New

### Leavenworth County and Participating Jurisdictions Mitigation Actions

Action Identification	Description	Hazard Addressed	Responsible Party	Overall Priority	Goal(s) Addressed	Estimated Cost	Potential Funding Source	Proposed Completion Timeframe	Current Status
							Jurisdiction budget		
Leavenworth-1	Purchase and install critical facility backup generators.	All hazards	City Manager	High	1, 2	\$25,000 - \$50,000 per facility	HMGP, BRIC, Jurisdiction budget	Five years	
Leavenworth-2	Install evacuation route and high ground signage in any high hazard dam or levee failure potential inundation areas.	Dam/Levee Failure	City Manager	Medium	1, 2, 4	\$5,000 per location	HMGP, Jurisdiction budget	Five years	New
Leavenworth-3	Conduct a native, low water planting program for all jurisdictional owned facilities	Drought	City Manager	Medium	1, 2	\$5,000 - \$20,000 per facility	HMGP, BRIC, Jurisdiction budget	Ten years	New
Leavenworth-4	Conduct a personal water use education program.	Drought	City Manager	Low	3	Staff time	HMGP, BRIC, Jurisdiction budget	Five years	New
Leavenworth-5	Identify and prepare local facilities to serve as heating/cooling centers.	Extreme Temperatures	City Manager	Medium	1, 2	\$3,000 per facility	HMGP, Jurisdiction budget	Five years	New
Leavenworth-6	Continue to participate meet requirements of the NFIP.	Flood	NFIP Coordinator	High	1, 2	Staff time	Jurisdiction budget	Continuous	On-going
Leavenworth-7	Construct rainwater retention/detention ponds at strategic locations.	Flood	City Manager	Low	1, 2	Location and size dependent	HMGP, BRIC, Jurisdiction budget	As required	
Leavenworth-8	Acquire and demolish flood prone properties within the city.	Flood	City Manager	Low	1, 2	Location, and size dependent	HMGP, BRIC, FMA, Jurisdiction budget	Ten years	
Leavenworth-9	Purchase a portable dam system to reduce exposure from flooding to the Leavenworth Community Center.	Flood	City Manager	Low	1, 2	\$200,000	HMGP, BRIC, FMA,	Five years	

### Leavenworth County and Participating Jurisdictions Mitigation Actions

Action Identification	Description	Hazard Addressed	Responsible Party	Overall Priority	Goal(s) Addressed	Estimated Cost	Potential Funding Source	Proposed Completion Timeframe	Current Status
							Jurisdiction budget		
Leavenworth-10	Purchase a portable dam system to reduce exposure from flooding to the City of Leavenworth Wastewater Treatment Plant.	Flood	City Manager	Low	1, 2	\$200,000	HMGP, BRIC, FMA, Jurisdiction budget	Five years	
Leavenworth-11	Seek Funding to construct a new City of Leavenworth Animal Control Shelter Building to replace the existing structure which is susceptible to repeated flooding events.	Flood	City Manager	Low	1, 2	\$2,000,000	HMGP, BRIC, FMA, Jurisdiction budget	Five years	
Leavenworth-12	Encourage the construction of safe rooms and storm shelters in public and private schools, day care centers and senior care facilities and early alert systems.	Severe Weather, Wildfires	City Manager	Low	1,2	Staff Time	Local, State, Federal	Repeating	Modified
Leavenworth-13	Install hail and fire-resistant roofing on all jurisdictional facilities.	Severe Weather, Wildfires	City Manager	Low	1, 2	\$50,000 per location	Facility size dependent	Five years	New
Leavenworth-14	Conduct public education program for driving in winter conditions.	Severe Winter Weather	City Manager	Low	4	Staff Time	Jurisdiction budget	Five years	Carried Over, Ongoing
Leavenworth-15	Create defensible space buffers at all critical facilities	Wildfire	Fire Chief	High	1, 2	Facility size dependent	HMGP, BRIC, Jurisdiction budget	As required	New
Linwood-1	Purchase and install critical facility backup generators.	All hazards	City Manager	High	1, 2	\$25,000 - \$50,000 per facility	HMGP, BRIC, Jurisdiction budget	Five years	
Linwood-2	Active building code enforcement to align with the national level.	All Hazards	Building Official	High	1,2	Staff Time	Jurisdiction budget	Repeating	New

### Leavenworth County and Participating Jurisdictions Mitigation Actions

Action Identification	Description	Hazard Addressed	Responsible Party	Overall Priority	Goal(s) Addressed	Estimated Cost	Potential Funding Source	Proposed Completion Timeframe	Current Status
Linwood-3	Install evacuation route signage in any high hazard dam or levee failure inundation areas.	Dam/Levee Failure	City Manager	Medium	1, 2, 4	\$5,000 per location	HMGP, Jurisdiction budget	Five years	New
Linwood-4	Conduct a native, low water planting program for all jurisdictional owned facilities	Drought	City Manager	Medium	1, 2	\$5,000 - \$20,000 per facility	HMGP, BRIC, Jurisdiction budget	Ten years	New
Linwood-5	Identify and prepare local facilities to serve as heating/cooling centers.	Extreme Temperatures	City Manager	Medium	1, 2	\$3,000 per facility	HMGP, Jurisdiction budget	Five years	New
Linwood-6	Continue to participate meet requirements of the NFIP.	Flood	NFIP Coordinator	High	1, 2	Staff time	Jurisdiction budget	Continuous	On-going
Linwood-7	Construct rainwater retention/detention ponds or other flood control projects at strategic locations.	Flood	City Manager	Low	1, 2	Location and size dependent	HMGP, BRIC, Jurisdiction budget	As required	
Linwood-8	Clean and repair drainage ditches to maintain capacity.	Flood	City Manager	Low	1, 2	Location, length, and size dependent	HMGP, BRIC, Jurisdiction budget	Ten years	New
Linwood-9	Install hail and fire-resistant roofing on all jurisdictional facilities.	Severe Weather, Wildfires	City Manager	Low	1, 2	\$50,000 per location	HMGP, BRIC, Jurisdiction budget	Five years	New
Linwood-10	Conduct public education program for driving in winter conditions.	Severe Winter Weather	City Manager	Low	4	Staff Time	Jurisdiction budget	Five years	New
Linwood-11	Construct community saferooms in select jurisdictional buildings.	Tornado	City Manager	High	1, 2	Facility size dependent	HMGP, BRIC, Jurisdiction budget	Ten years	New
Linwood-12	Create defensible space buffers at all critical facilities	Wildfire	Fire Chief	High	1, 2	Facility size dependent	HMGP, BRIC, Jurisdiction budget	As required	New

### Leavenworth County and Participating Jurisdictions Mitigation Actions

Action Identification	Description	Hazard Addressed	Responsible Party	Overall Priority	Goal(s) Addressed	Estimated Cost	Potential Funding Source	Proposed Completion Timeframe	Current Status
Tonganoxie-1	Develop and fund professional services to augment the City of Tonganoxie's GIS capability.	All hazards	City Manager	High	1, 2	\$65,000	HMGP, BRIC, Jurisdiction budget	Five years	
Tonganoxie-2	Create a working group to assess the county's firefighting / EMS resources to identify any existing needs or shortfalls in terms of personnel, equipment or additional required resources. Complete all recommendations.	All Hazards	Fire Chief	High	1,2	Staff Time, \$30,000	Jurisdiction budget	Five years	
Tonganoxie-3	Install evacuation route signage in any high hazard dam or levee failure inundation areas.	Dam/Levee Failure	City Manager	Medium	1, 2, 4	\$5,000 per location	HMGP, Jurisdiction budget	Five years	New
Tonganoxie-4	Conduct a native, low water planting program for all jurisdictional owned facilities	Drought	City Manager	Medium	1, 2	\$5,000 - \$20,000 per facility	HMGP, BRIC, Jurisdiction budget	Ten years	New
Tonganoxie-5	Identify and prepare local facilities to serve as heating/cooling centers.	Extreme Temperatures	City Manager	Medium	1, 2	\$3,000 per facility	HMGP, Jurisdiction budget	Five years	New
Tonganoxie-6	Continue to participate meet requirements of the NFIP.	Flood	NFIP Coordinator	High	1, 2	Staff time	Jurisdiction budget	Continuous	On-going
Tonganoxie-7	Design and complete and construction of stream bank stabilization on Tonganoxie Creek within the city limits of Tonganoxie.	Flood	City Engineer	Medium	1, 2	\$25,000	HMGP, BRIC, Jurisdiction budget	Five years	
Tonganoxie-8	Identify flash-flood prone areas to consider flood reduction measures to city planners. Flood zone mapping has provided initial identification of potential hazard areas that can be reviewed with other data sources, such as the watershed districts goals and objectives, in developing long range planning activities for flood prevention,	Flood	City Engineer	Low	1, 2	\$100,000	HMGP, BRIC, Jurisdiction budget	Five years	New

### Leavenworth County and Participating Jurisdictions Mitigation Actions

Action Identification	Description	Hazard Addressed	Responsible Party	Overall Priority	Goal(s) Addressed	Estimated Cost	Potential Funding Source	Proposed Completion Timeframe	Current Status
	or other planning steps to reduce exposure to this hazard.								
Tonganoxie-9	Research and fund engineering services for a city-wide storm water infrastructure-needs assessment.	Flood	City Engineer	Low	1, 2	\$25,000	HMGP, BRIC, Jurisdiction budget	Five years	
Tonganoxie-10	Install hail and fire-resistant roofing on all jurisdictional facilities.	Severe Weather, Wildfires	City Manager	Low	1, 2	\$50,000 per location	HMGP, BRIC, Jurisdiction budget	Five years	New
Tonganoxie-11	Incorporate the inspection and management of trees into the city maintenance program that may pose a threat to the electrical lines that could result in power outages during ice storms.	Severe Winter Weather	City Manager	Low	1,2	\$10,000	Jurisdiction budget	Five years	
Tonganoxie-12	Construct community saferooms in select jurisdictional buildings.	Tornado	City Manager	High	1, 2	Facility size dependent	HMGP, BRIC, Jurisdiction budget	Ten years	New
Tonganoxie-13	Create defensible space buffers at all critical facilities	Wildfire	Fire Chief	High	1, 2	Facility size dependent	HMGP, BRIC, Jurisdiction budget	As required	New
USD207-1	Conduct hazard mitigation education programs for students.	All hazards	Superintendent	Medium	1, 2, 3	\$2,000	School Budget	As required	New
USD207-2	Conduct a native, low water planting program for all school owned facilities	Drought	Superintendent	Low	1, 2	\$10,000 -per location	HMGP, BRIC, School Budget	Ten years	New
USD207-3	Conduct an extreme temperature awareness seminar to educate on risks and mitigation methods.	Extreme Temperature, Severe Winter Weather	Superintendent	Medium	1, 2	\$500	HMGP, Jurisdiction budget	Five years	New

### Leavenworth County and Participating Jurisdictions Mitigation Actions

Action Identification	Description	Hazard Addressed	Responsible Party	Overall Priority	Goal(s) Addressed	Estimated Cost	Potential Funding Source	Proposed Completion Timeframe	Current Status
USD207-4	Construct rainwater gardens adjacent to paved areas.	Flood	Superintendent	Low	1, 2	Location and size dependent	HMGP, BRIC, School Budget	As required	New
USD207-5	Install hail and fire-resistant roofing on all jurisdictional facilities.	Severe Weather, Wildfires	Superintendent	Low	1, 2	\$100,000 per location	Facility size dependent	Five years	New
USD207-6	The safe room for the new school will be located on the lower level; however, it will have an on-grade entrance/exit due to the terrain of the site. Three walls are below grade. The elevator will allow the 2nd and 3rd floor staff and students with disabilities (and wheelchair bound students) to access the safe room.	Tornado	Superintendent	High	1, 2	\$28,600,000	HMGP, BRIC, School Budget	Five years	
USD207-7	Construct safe rooms in all school buildings to required standards.	Tornado	Superintendent	High	1, 2	\$1,000,000 - per location	HMGP, BRIC, School budget	Ten years	
USD207-8	Conduct regular staff and student active shooter trainings.	Terrorism	Superintendent	High	1, 2, 3	Location and size dependent	HMGP, School Budget	As required	New
USD449-1	Purchase and install facility backup generators.	All hazards	Superintendent	High	1, 2	\$10,000 - \$50,000 per facility	HMGP, BRIC, School Budget	Five years	
USD449-2	Conduct hazard mitigation education programs for students.	All hazards	Superintendent	Medium	1, 2, 3	\$2,000	School Budget	As required	New
USD449-3	Conduct a native, low water planting program for all school owned facilities	Drought	Superintendent	Low	1, 2	\$10,000 -per location	HMGP, BRIC, School Budget	Five years	New
USD449-4	Conduct an extreme temperature awareness seminar to educate on risks and mitigation methods.	Extreme Temperature,	Superintendent	Medium	1, 2	\$500	HMGP, Jurisdiction budget	Five years	New



### Leavenworth County and Participating Jurisdictions Mitigation Actions

Action Identification	Description	Hazard Addressed	Responsible Party	Overall Priority	Goal(s) Addressed	Estimated Cost	Potential Funding Source	Proposed Completion Timeframe	Current Status
		Severe Winter Weather							
USD449-5	Construct rainwater gardens adjacent to paved areas.	Flood	Superintendent	Low	1, 2	Location and size dependent	HMGP, BRIC, School Budget	As required	New
USD449-6	Install hail and fire-resistant roofing on all jurisdictional facilities.	Severe Weather, Wildfires	Superintendent	Low	1, 2	\$100,000 per location	Facility size dependent	Five years	New
USD449-7	Construct safe rooms in all school buildings to required standards.	Tornado	Superintendent	High	1, 2	\$1,000,000 - per location	HMGP, BRIC, School budget	Ten years	
USD449-8	Conduct regular staff and student active shooter trainings.	Terrorism	Superintendent	High	1, 2, 3	Location and size dependent	HMGP, School Budget	As required	New
USD453-1	Purchase and install facility backup generators.	All hazards	Superintendent	High	1, 2	\$10,000 - \$50,000 per facility	HMGP, BRIC, School Budget	Five years	
USD453-2	Conduct hazard mitigation education programs for students.	All hazards	Superintendent	Medium	1, 2, 3	\$2,000	School Budget	As required	New
USD453-3	Conduct a native, low water planting program for all school owned facilities	Drought	Superintendent	Low	1, 2	\$10,000 -per location	HMGP, BRIC, School Budget	Five years	New
USD453-4	Conduct an extreme temperature awareness seminar to educate on risks and mitigation methods.	Extreme Temperature, Severe Winter Weather	Superintendent	Medium	1, 2	\$500	HMGP, Jurisdiction budget	Five years	New
USD453-5	Construct rainwater gardens adjacent to paved areas.	Flood	Superintendent	Low	1, 2	Location and size dependent	HMGP, BRIC, School Budget	As required	New

### Leavenworth County and Participating Jurisdictions Mitigation Actions

Action Identification	Description	Hazard Addressed	Responsible Party	Overall Priority	Goal(s) Addressed	Estimated Cost	Potential Funding Source	Proposed Completion Timeframe	Current Status
USD453-6	Install hail and fire-resistant roofing on all jurisdictional facilities.	Severe Weather, Wildfires	Superintendent	Low	1, 2	\$100,000 per location	Facility size dependent	Five years	New
USD453-7	Construct safe rooms in all school buildings to required standards.	Tornado	Superintendent	High	1, 2	\$1,000,000 - per location	HMGP, BRIC, School budget	Ten years	
USD453-8	Conduct regular staff and student active shooter trainings.	Terrorism	Superintendent	High	1, 2, 3	Location and size dependent	HMGP, School Budget	As required	New
USD458-1	Purchase and install facility backup generators.	All hazards	Superintendent	High	1, 2	\$10,000 - \$50,000 per facility	HMGP, BRIC, School Budget	Five years	
USD458-2	Conduct hazard mitigation education programs for students.	All hazards	Superintendent	Medium	1, 2, 3	\$2,000	School Budget	As required	New
USD458-3	Conduct a native, low water planting program for all school owned facilities	Drought	Superintendent	Low	1, 2	\$10,000 -per location	HMGP, BRIC, School Budget	Five years	New
USD458-4	Conduct an extreme temperature awareness seminar to educate on risks and mitigation methods.	Extreme Temperature, Severe Winter Weather	Superintendent	Medium	1, 2	\$500	HMGP, Jurisdiction budget	Five years	New
USD458-5	Assess elevations and water flow in the district to qualify the benefit of flood control projects in the District. Complete recommended projects.	Flood	Superintendent	Low	1, 2	Location and size dependent	HMGP, BRIC, School Budget	As required	
USD458-6	Install hail and fire-resistant roofing on all jurisdictional facilities.	Severe Weather, Wildfires	Superintendent	Low	1, 2	\$100,000 per location	Facility size dependent	Five years	New
USD458-7	Construct safe rooms in all school buildings to required standards.	Tornado	Superintendent	High	1, 2	\$1,000,000 - per location	HMGP, BRIC, School budget	Ten years	

### Leavenworth County and Participating Jurisdictions Mitigation Actions

Action Identification	Description	Hazard Addressed	Responsible Party	Overall Priority	Goal(s) Addressed	Estimated Cost	Potential Funding Source	Proposed Completion Timeframe	Current Status
USD458-8	Conduct regular staff and student active shooter trainings.	Terrorism	Superintendent	High	1, 2, 3	Location and size dependent	HMGP, School Budget	As required	New
USD464-1	Purchase and install facility backup generators.	All hazards	Superintendent	High	1, 2	\$10,000 - \$50,000 per facility	HMGP, BRIC, School Budget	Five years	
USD464-2	Conduct hazard mitigation education programs for students.	All hazards	Superintendent	Medium	1, 2, 3	\$2,000	School Budget	As required	New
USD464-3	Conduct a native, low water planting program for all school owned facilities	Drought	Superintendent	Low	1, 2	\$10,000 -per location	HMGP, BRIC, School Budget	Five years	New
USD464-4	Conduct an extreme temperature awareness seminar to educate on risks and mitigation methods.	Extreme Temperature, Severe Winter Weather	Superintendent	Medium	1, 2	\$500	HMGP, Jurisdiction budget	Five years	New
USD464-5	Construct rainwater gardens adjacent to paved areas.	Flood	Superintendent	Low	1, 2	Location and size dependent	HMGP, BRIC, School Budget	As required	New
USD464-6	Install hail and fire-resistant roofing on all jurisdictional facilities.	Severe Weather, Wildfires	Superintendent	Low	1, 2	\$100,000 per location	Facility size dependent	Five years	New
USD464-7	Construct safe rooms in all school buildings to required standards.	Tornado	Superintendent	High	1, 2	\$1,000,000 - per location	HMGP, BRIC, School budget	Ten years	
USD464-8	Conduct regular staff and student active shooter trainings.	Terrorism	Superintendent	High	1, 2, 3	Location and size dependent	HMGP, School Budget	As required	
USD469-1	Purchase and install facility backup generators.	All hazards	Superintendent	High	1, 2	\$10,000 - \$50,000 per facility	HMGP, BRIC, School Budget	Five years	

### Leavenworth County and Participating Jurisdictions Mitigation Actions

Action Identification	Description	Hazard Addressed	Responsible Party	Overall Priority	Goal(s) Addressed	Estimated Cost	Potential Funding Source	Proposed Completion Timeframe	Current Status
USD469-2	Conduct hazard mitigation education programs for students.	All hazards	Superintendent	Medium	1, 2, 3	\$2,000	School Budget	As required	New
USD469-3	Conduct a native, low water planting program for all school owned facilities	Drought	Superintendent	Low	1, 2	\$10,000 -per location	HMGP, BRIC, School Budget	Five years	New
USD469-4	Conduct an extreme temperature awareness seminar to educate on risks and mitigation methods.	Extreme Temperature, Severe Winter Weather	Superintendent	Medium	1, 2	\$500	HMGP, Jurisdiction budget	Five years	New
USD469-5	Construct rainwater gardens adjacent to paved areas.	Flood	Superintendent	Low	1, 2	Location and size dependent	HMGP, BRIC, School Budget	As required	New
USD469-6	Install hail and fire-resistant roofing on all jurisdictional facilities.	Severe Weather, Wildfires	Superintendent	Low	1, 2	\$100,000 per location	Facility size dependent	Five years	New
USD469-7	Construct safe rooms in all school buildings to required standards.	Tornado	Superintendent	High	1, 2	\$1,000,000 - per location	HMGP, BRIC, School budget	Ten years	
USD469-8	Conduct regular staff and student active shooter trainings.	Terrorism	Superintendent	High	1, 2, 3	Location and size dependent	HMGP, School Budget	As required	
U. St. Mary-1	Incorporate the inspection and management of trees into the University's routine maintenance process to remove trees that may increase the risk of power failure throughout the campus infrastructure.	All hazards	President	Medium	1, 2	\$10,000	HMGP, School Budget	Five years	
U. St. Mary -2	Appoint a committee to develop a radio communications plan between campus security units and outside agencies of Leavenworth County and the City of	All hazards	President	Medium	4	Staff Time	School budget	Five years	

### Leavenworth County and Participating Jurisdictions Mitigation Actions

Action Identification	Description	Hazard Addressed	Responsible Party	Overall Priority	Goal(s) Addressed	Estimated Cost	Potential Funding Source	Proposed Completion Timeframe	Current Status
	Leavenworth to ensure interoperability between all communities.								
U. St. Mary -3	Appoint a committee to research and implement enhancement to the University's early warning systems for students and staff for weather alerts and campus emergencies.	All hazards	President	Medium	1, 2, 4	Staff Time	School Budget	As required	New
U. St. Mary -4	Conduct a native, low water planting program for all university owned facilities	Drought	President	Low	1, 2	\$10,000 -per location	HMGP, BRIC, School Budget	Ten years	New
U. St. Mary -5	Conduct an extreme temperature awareness seminar to educate on risks and mitigation methods.	Extreme Temperature, Severe Winter Weather	President	Medium	1, 2	\$500	HMGP, Jurisdiction budget	Five years	New
U. St. Mary -6	Construct rainwater gardens adjacent to paved areas.	Flood	President	Low	1, 2	Location and size dependent	HMGP, BRIC, School Budget	As required	New
U. St. Mary -7	Install hail and fire-resistant roofing on all jurisdictional facilities.	Severe Weather, Wildfires	President	Low	1, 2	\$100,000 per location	Facility size dependent	Five years	New
U. St. Mary -8	Conduct regular staff and student active shooter trainings.	Terrorism	President	High	1, 2, 3	Location and size dependent	HMGP, School Budget	As required	New
Leavenworth Rural Water District #7-1	Replace and upgrade pump stations and water lines.	Drought, Wildfire	Director	High	1,2	Location and size dependent	BRIC, HMGP, Jurisdiction budget	Ten years	New
Leavenworth Rural Water District #7-2	Maintain, repair, and collect GPS locations of fire hydrants within the area served by Leavenworth RWD#7.	Wildfire	Director	High	1,2	Staff time	Jurisdiction budget,	Ten years	
Water One Water District 1-1	Purchase emergency generators for facilities to ensure continued operations.	All Hazards	Director	High	1,2	\$100,000	Jurisdiction budget, State grant,	Two years	New

Leavenworth County and Participating Jurisdictions Mitigation Actions

Action Identification	Description	Hazard Addressed	Responsible Party	Overall Priority	Goal(s) Addressed	Estimated Cost	Potential Funding Source	Proposed Completion Timeframe	Current Status
	Loss of power could potentially curtail services to the community.						Federal grant		
Water One Water District 1-2	Replace and upgrade pump stations and water lines.	Drought, Wildfire	Director	High	1,2	Location and size dependent	Jurisdiction budget, State grant, Federal grant	Ten years	New

## **RESOLUTION No. 2025-16**

### **A RESOLUTION BY THE BOARD OF COUNTY COMMISSIONERS OF LEAVENWORTH COUNTY, KANSAS ENACTING ON THE ADOPTION OF THE COUNTYWIDE MULTI-JURISDICTIONAL HAZARD MITIGATION PLAN REGION L**

**Whereas**, The Leavenworth County Board of County Commissioners recognizes the threat that natural hazards pose to people and property within our community; and

**Whereas**, undertaking hazard mitigation actions will reduce the potential for harm to people and property from future hazard occurrences, and

**Whereas**, the U.S. Congress passed the Disaster Mitigation Act of 2000 (“Disaster Mitigation Act”) emphasizing the need for pre-disaster mitigation of potential hazards;

**Whereas**, the Disaster Mitigation Act made available hazard mitigation grants to state and local governments; and

**Whereas**; an adopted Hazard Mitigation Plan is required as a condition of future funding for mitigation projects under multiple Federal Emergency Management Agency (FEMA) pre-and post-disaster mitigation grant programs; and

**Whereas**; The County of Leavenworth fully participated in the FEMA prescribed mitigation planning process to prepare this Multi-Hazard Mitigation Plan; and

**Whereas**; the Kansas Division of Emergency Management and FEMA region VII officials have reviewed the Kansas Homeland Security Region L Hazard Mitigation Plan, and approved it contingent upon this official adoption of the participating governing body; and

**Whereas**; the Leavenworth County Board of County Commissioners desires to comply with the requirements of the Disaster Mitigation Act and to augment its emergency planning efforts by formally adopting the Kansas Homeland Security Region L Hazard Mitigation Plan; and

**Whereas;** adopting by the governing body for the County of Leavenworth demonstrates the jurisdictions' commitment to fulfilling the mitigation goals and objectives outlined in this plan, and

**Whereas;** adoption of this legitimizes the plan and authorizes responsible agencies to carry out their responsibilities under the plan.

**Now, there forth, be it resolved,** that the Leavenworth County Board of County Commissioners adopts the Kansas Homeland Security Region L Hazard Mitigation Plan as an official plan; and

**Be it further resolved,** the Leavenworth County Board of County Commissioners will submit this adoption Resolution to the Kansas Division of Emergency Management and FEMA Region VII officials to enable the plan's final approval on this \_\_\_\_\_ Day of April 2025.

Board of County Commissioners  
Of Leavenworth County:

---

Mike Smith 4<sup>th</sup> District Commissioner, Chairman

---

Jeff Culbertson 1st District Commissioner

---

Vanessa Reid 2nd District Commissioner

---

Willie Dove 3rd District Commissioner

---

Mike Stieben 5th District Commissioner

Attest: \_\_\_\_\_  
Fran Kepler, County Clerk



**Leavenworth County  
Request for Board Action**

**Date:** April 30, 2025

**To:** Board of County Commissioners

**Cc:** Mark Loughry, County Administrator

**From:** Jon Khalil, Deputy County Counselor

**Department Head Approval:** N/A

**Additional Reviews as needed:**

**Budget Review** ☐ **Administrator Review** ☐ **Legal Review** ☒

---

---

**Action Requested:** Consideration of a Resolution altering the boundaries of Rural Fire District No. 1 of Leavenworth County, Kansas (“Fire District No. 1”) to remove High Prairie Township which will result in Fire District No.1 having no remaining territory within its jurisdiction.

**Recommendation:** Consideration and approval of a Resolution (attached) altering Fire District No. 1 to remove High Prairie Township from Fire District No. 1.

**Analysis:**

- Fire District No. 1 was formed in 2003 by the Board of County Commissioners of Leavenworth County, Kansas (“County”) and is comprised of the City of Lansing, Delaware Township, and High Prairie Township.
- The County, the City of Lansing, Delaware Township and High Prairie Township all entered into an Interlocal Agreement, and the County delegated all of the governing powers of Fire District No. 1 to a board of trustees to govern the joint operation and management of the Fire District No. 1.
- The Interlocal Agreement was terminated on December 31, 2024, and the County became the governing body of Fire District No. 1 on January 1, 2025.
- The County was required to arrange for the provision of fire protection services within Fire District No. 1 and entered into a contract with the City of Lansing to provide fire protection services within the boundaries of Fire District No. 1 for a period of one year.
- On February 6, 2025 the County received a petition from High Prairie Township for the alteration of the boundaries of Fire District No. 1 by detaching and excluding the High Prairie Township from Fire District No. 1.
- K.S.A. 19-3604 provides that the Board of County Commissioners may adopt and publish a resolution attaching or detaching the lands described from the fire district upon a sufficient petition to the Board of County Commissioners.
- The resolution and map showing the territory of the district and the lands proposed to be detached therefrom has been published once each week for two consecutive weeks in the official County newspaper.

- No protest petition in accordance with K.S.A. 19-3604 was filed regarding the alteration of the boundaries of Fire District No. 1.
- K.S.A. 19-3604 requires that the Board of County Commissioners declare the new boundaries of Fire District No. 1 in a like manner as the boundaries were declared at the time of the original organization of Fire District No. 1.
- The proposed resolution declares that High Prairie Township will be removed from Fire District No. 1.
- As a result of that removal, Fire District No. 1 will have no remaining territory within its jurisdiction.
- The resolution and map showing altered boundaries of Fire District No. 1 will be published in the official county newspaper one time after adoption in accordance with K.S.A. 19-3602.

**Alternatives:** 1) Decline to alter the boundaries of Fire District No. 1; 2) Table the matter for further study.

**Budgetary Impact:**

- ☒ Not Applicable
- ☐ Budgeted item with available funds
- ☐ Non-Budgeted item with available funds through prioritization
- ☐ Non-Budgeted item with additional funds requested

**Total Amount Requested:** Incidental publication costs

**Additional Attachments:**

Resolution

Map



# LEAVENWORTH COUNTY KANSAS 2025

## Fire Districts #1 Map

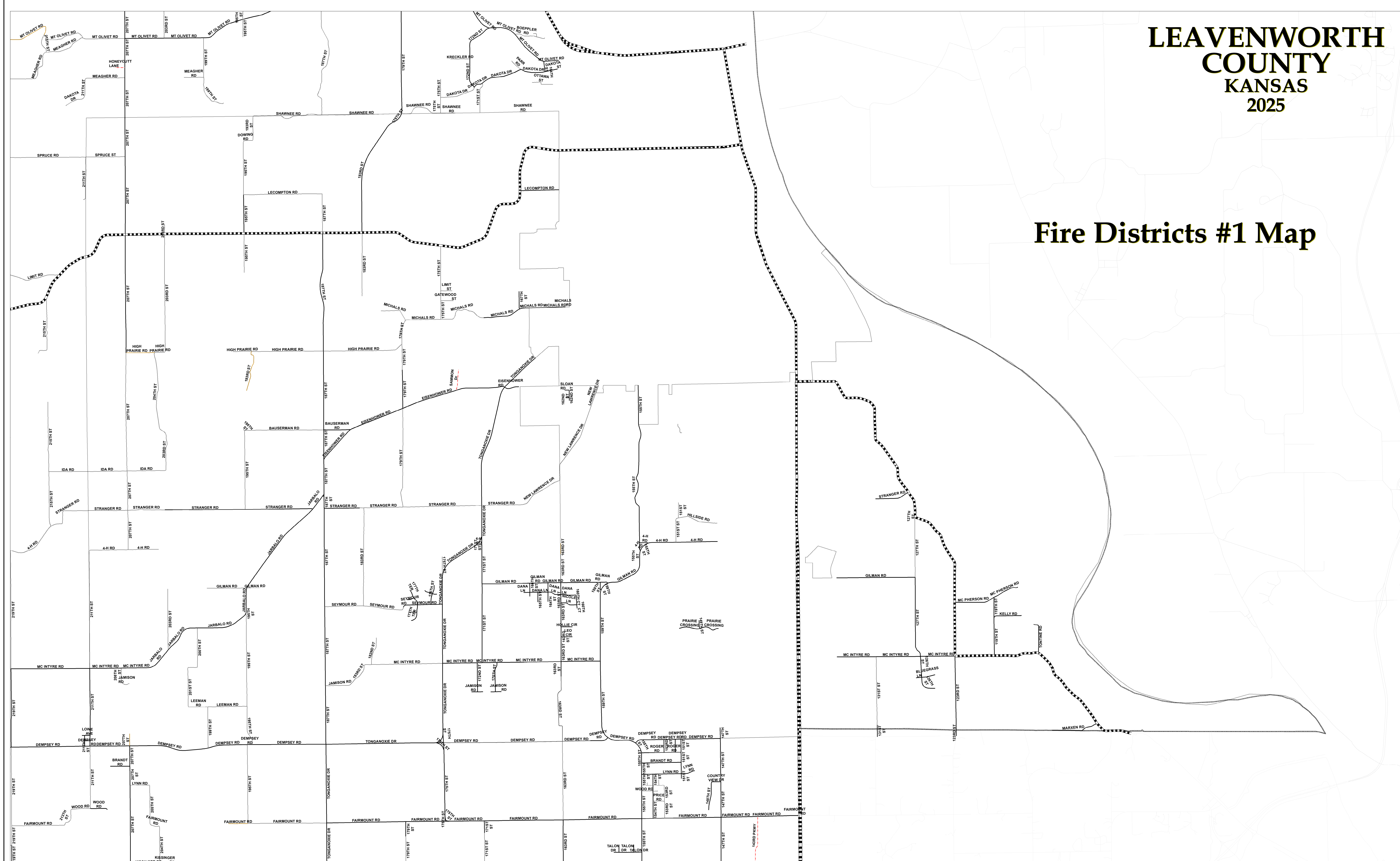

**Note: Fire District #1 has no remaining territory within its jurisdiction.**

### Legend

- GRAVEL
- HARD SURFACE
- State Maintained
- MINIMUM
- PRIVATE

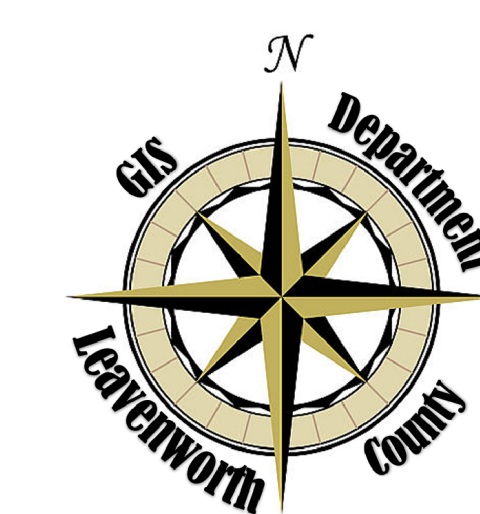

Leavenworth County  
GIS Services  
300 Walnut Suite 030  
Leavenworth, KS 66048  
Ph: 913-758-6780  
Ph: 913-684-0443



0 1.25 2.5 5 Miles



**RESOLUTION NO. 2025-17**

**A RESOLUTION OF THE BOARD OF COUNTY COMMISSIONERS OF  
LEAVENWORTH, KANSAS DECLARING THE NEW BOUNDARIES OF RURAL  
FIRE DISTRICT NO.1 OF LEAVENWORTH COUNTY, KANSAS.**

**WHEREAS**, Rural Fire District No. 1 of Leavenworth County, Kansas (“Fire District No. 1”) was formed in 2003 by the Board of County Commissioners of Leavenworth County, Kansas (“County”) under K.S.A. 19-3601 et. seq, the Fire Protection Act; and

**WHEREAS**, The Fire District No. 1 was comprised of the City of Lansing, Delaware Township, and High Prairie Township; and

**WHEREAS**, the County, the City of Lansing, Delaware Township and High Prairie Township all entered into an Interlocal Agreement under K.S.A. 12-2901, et. seq., the Interlocal Cooperation Act; and

**WHEREAS**, the County delegated all of the governing powers of Fire District No. 1 to a board of trustees in the Interlocal Agreement under K.S.A. 12-3612a, and the Interlocal Agreement set forth the terms and conditions governing the joint operation and management of the Fire District; and

**WHEREAS**, the Interlocal Agreement was terminated on December 31, 2024, and the County became and constituted the governing body of Fire District No. 1 under K.S.A. 19-3601 on January 1, 2025; and

**WHEREAS**, K.S.A. 19-3604(b) sets forth the process for the alteration of a fire district and;

**WHEREAS**, the City of Lansing was detached from Fire District No. 1 on March 12, 2025 and new boundaries of Fire District No. 1 were declared on April 23, 2023 to include only Delaware Township and High Prairie Township; and

**WHEREAS**, Delaware Township was detached from Fire District No. 1 on March 19, 2025 and new boundaries of Fire District No. 1 were declared on April 30, 2024 to include only High Prairie Township; and

**WHEREAS**, on February 6, 2025 the County received a sufficient petition from High Prairie Township pursuant to K.S.A. 19-3604(b) for the alteration of Fire District No. 1, and seeking the exclusion of High Prairie Township from Fire District No. 1; and

**WHEREAS**, the Board of County Commissioners adopted Resolution No. 2025-12 on March 26, 2025, detaching High Prairie Township from Fire District No. 1 and finding that the petition submitted by High Prairie Township was sufficient and conformed as near as may be possible to the petition required for the organization of the fire district; and

**WHEREAS**, the Resolution 2025-12 was published in the Leavenworth Times for two consecutive weeks on March 29, 2025 and April 5, 2025 as required by K.S.A. 19-3604 and the 30-day period for a protest petition has passed with no such petition being filed.

**NOW THEREFORE, THE BOARD OF COUNTY COMMISSIONERS OF  
LEAVENWORTH COUNTY, KANSAS SITTING IN REGULAR SESSION DOES  
HEREBY RESOLVE:**

1. That the High Prairie Township is detached and removed from the boundaries of Fire District No. 1 thereby resulting in Fire District No. 1 having no remaining territory within its jurisdiction; and
2. That this Resolution and the attached map of the new boundaries shall be published in the manner required by K.S.A. 19-3604.

Staff is authorized and directed to prepare and publish the statutory notices and prepare all other necessary and appropriate documentation to accomplish the alteration and declaration of the new boundaries of Fire District No. 1.

ADOPTED the 7th day of May, 2025.

BOARD OF COUNTY COMMISSIONERS  
OF LEAVENWORTH COUNTY, KANSAS

---

Mike Smith, CHAIR

---

Jeff Culbertson, MEMBER

---

Vanessa Reid, MEMBER

---

Willie Dove, MEMBER

---

Mike Stieben, MEMBER

ATTEST:

---

Fran Keppler, CLERK

## Leavenworth County Request for Board Action

**Date:** April 30, 2025

**To:** Board of County Commissioners

**Cc:** Mark Loughry, County Administrator

**From:** Misty Brown, County Counselor

**Department Head Approval:** N/A

**Additional Reviews as needed:**

**Budget Review** ☐ **Administrator Review** ☐ **Legal Review** ☐

---

---

**Action Requested:** Conduct a public hearing and consider the petition for the attachment of certain properties to Rural Water District No. 7 of Leavenworth County, Kansas.

**Recommendation:** Approval of the Petition and Order for Attachment of Lands to Rural Water District No. 7, Leavenworth County.

**Analysis:** A Petition signed by not less than 50% of land owners was directed to the Board of County Commissioners seeking the attachment of lands to the existing territory of Rural Water District No. 7. The lands proposed for attachment are in both Leavenworth County and Wyandotte County. State law requires Leavenworth County to consider the matter because the greatest portion of Water District No. 7 is within Leavenworth County. Staff reached out to Wyandotte County and received confirmation that the Kansas City, Kansas Board of Public Utilities does not provide water service to the proposed service area in Wyandotte County and does not intend to intervene in the matter.

The Petition states that:

- The lands seeking attachment are without adequate water supply and can be most economically served by the facilities of Rural Water District No. 7; and
- That the attachment of this land to Rural Water District No. 7 will be conducive to and will promote the public health, convenience and welfare; and
- The Board of Directors of Water District No. 7 has considered and consents to the Request.

Under K.S.A.82a-624, the Board of County Commissioners is required to ascertain the following:

- Whether proper notice has been given as required by K.S.A. 82a-623, and
- Whether the statements contained in the petition are true, and
- If the Water District Board of the district to which attachment is desired objects to the Request.

Here, proper notice was given as required; the petition and notice of hearing was sent via first class mail to all of the landowners in the land to be attached to the district and to the office of the Rural Water District No. 7 Leavenworth County, Kansas. Notice was also transmitted to the Chief Engineer of the Division of Water Resources, Kansas Department of Agriculture as required by statute.

If the Board finds that proper notice has been given, that the statements in the petition are true, and that a majority of the Board of Directors of Rural Water District No. 7 do not object to the attachment, then the attachment to the water district should be approved.

**Alternatives:** 1) Deny only with a finding that statements in the petition are untrue; or 2) Table the matter for further study.

**Budgetary Impact:**

- ☒ Not Applicable
- ☐ Budgeted item with available funds
- ☐ Non-Budgeted item with available funds through prioritization
- ☐ Non-Budgeted item with additional funds requested

**Total Amount Requested:**

**Additional Attachments:**

Proposed Order  
Petition  
Map  
Notice of Hearing

BEFORE THE BOARD OF COUNTY COMMISSIONERS OF  
LEAVENWORTH COUNTY, KANSAS

IN THE MATTER OF THE PETITION FOR THE  
ATTACHMENT OF LANDS TO RURAL WATER  
DISTRICT NO. 7, LEAVENWORTH COUNTY, KANSAS

**PETITION FOR ATTACHMENT OF  
LANDS TO RURAL WATER DISTRICT NO. 7  
LEAVENWORTH COUNTY, KANSAS  
PURSUANT TO K.S.A. 82a-622 et seq.**

COMES NOW Petitioner, Todd A. Luckman of Stumbo Hanson, LLP and states as follows:

1. Petitioner is the attorney for Rural Water District No. 7, Leavenworth County, Kansas, with offices at 2887 SW MacVicar Ave., Topeka, Kansas 66611.

2. Petitioner is in receipt of Requests for Petitioning signed by not less than 50% of the owners of lands described below, as determined from the tax rolls of the counties in which such lands are located (Leavenworth and Wyandotte Counties), praying for attachment to Rural Water District No. 7, Leavenworth County, Kansas.

3. The attached Exhibit "A" reflects three areas marked in red, one in Leavenworth County (marked "LV1") and two in Wyandotte County (marked "WYCO1" and "WYCO2") which are the areas sought to be attached by the Petitioners. That Exhibit further reflects a solid blue outline which would represent the resulting, final boundaries of Rural Water District No. 7, Leavenworth County, Kansas following these requested attachments.

4. The Requests for Petitioning and ownership information from the tax records of Leavenworth County, Kansas for the properties seeking to be attached which are located in Leavenworth County are attached as Exhibit "B".



5. The lands sought to be attached which are in Leavenworth County, Kansas, are described by metes and bounds as follows:

*See Exhibit "C", attached hereto.*

6. The Requests for Petitioning and ownership information from the tax records of Wyandotte County, Kansas for the properties seeking to be attached which are located in Wyandotte County are attached as Exhibit "D".

7. The lands sought to be attached which are in Wyandotte County, Kansas, are described by metes and bounds as follows:

*See Exhibit "E", attached hereto.*

8. While these lands are located in Wyandotte County, Kansas, K.S.A. 82a-612(c) requires that the Petitioner request this action of the Leavenworth County Commission as the greatest portion of the territory of Rural Water District No. 7, Leavenworth County, Kansas is located in Leavenworth County, Kansas.

9. Such lands are without an adequate supply of water and can be most economically served by facilities of the District.

10. Attachment of such lands to the District will be conducive to and will promote the public health, convenience and welfare.

11. The Board of Directors of Rural Water District No. 7, Leavenworth County, Kansas, has considered the Request for Petitioning of adjoining lands and consents thereto.

WHEREFORE, Petitioner hereby requests that the Board of County Commissioners, Leavenworth County, Kansas, enter into its minutes a finding that proper notice of the hearing has been given as required by K.S.A. 82a-623; that the statements contained in the Petition are true;



# EXHIBIT

## Areas to be Included

PREPARED FOR:  
RWD7

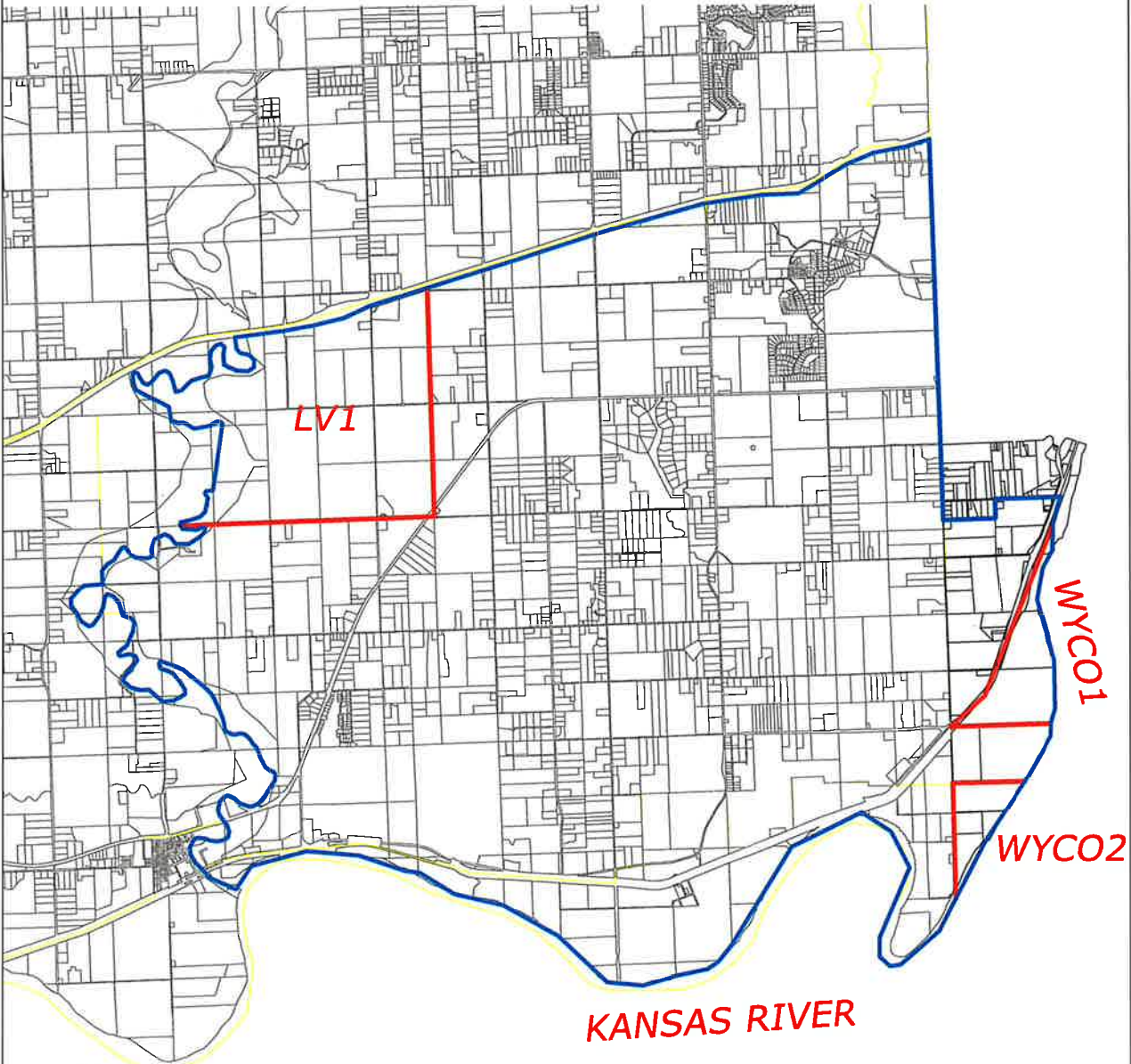

Scale 1" = 5000'

Job # K-22-1554-24  
June 23, 2024



J. Herring, Inc. (dba)  
**HERRING**  
SURVEYING  
COMPANY

315 North 5th Street, Leav., KS 66048  
Ph. 913.651.3858 Fax 913.674.5381  
Email - survey@teamcash.com

**THIS DOES NOT CONSTITUTE A BOUNDARY SURVEY**

## REQUEST FOR PETITIONING

We/I, the undersigned, request that the attorneys of Stumbo Hanson, LLP direct a Petition to the Board of County Commissioners of Leavenworth County, Kansas, such Petition seeking attachment of our land to the territory of Rural Water District No. 7, Leavenworth County, Kansas.

SIGNATURE(S) OF PETITIONER(S):

  
SARAH R. FREDERICK REVOCABLE TRUST  
U/T/A DATED FEBRUARY 11, 2022

BY: Sarah R. Frederick TRUSTEE  
(Print)

August 1, 2022  
Date

QUICK REFERENCE ID:

R25175

PROPERTY ADDRESS:

00000 182<sup>nd</sup> Street  
Tonganoxie, KS 66086

OWNER MAILING ADDRESS(ES):

Sarah R. Frederick Revocable Living Trust  
7224 Jarboe  
Kansas City, MO 64141

## REQUEST FOR PETITIONING

We/I, the undersigned, request that the attorneys of Stumbo Hanson, LLP direct a Petition to the Board of County Commissioners of Leavenworth County, Kansas, such Petition seeking attachment of our land to the territory of Rural Water District No. 7, Leavenworth County, Kansas.

SIGNATURE(S) OF PETITIONER(S):



SARAH R. FREDERICK REVOCABLE TRUST  
U/T/A DATED FEBRUARY 11, 2022

BY: Sarah R. Frederick TRUSTEE  
(Print)

August 1, 2022  
Date

QUICK REFERENCE ID:

R25176

PROPERTY ADDRESS:

18369 Hemphill Rd  
Tonganoxie, KS 66086

OWNER MAILING ADDRESS(ES):

Sarah R. Frederick Revocable Living Trust  
7224 Jarboe  
Kansas City, MO 64141

Sherry Reeves -  
Chris

## REQUEST FOR PETITIONING

We/I, the undersigned, request that the attorneys of Stumbo Hanson, LLP direct a Petition to the Board of County Commissioners of Leavenworth County, Kansas, such Petition seeking attachment of our land to the territory of Rural Water District No. 7, Leavenworth County, Kansas.

SIGNATURE(S) OF PETITIONER(S):

Sherry Reeves  
USD 458

BY: Sherry Reeves, Interim Superintendent  
(Print Name and Title)

July 30, 2021  
Date

QUICK REFERENCE ID:

R308348

PROPERTY ADDRESS:

14840 178<sup>th</sup> St.  
Bonner Springs, KS 66012

OWNER MAILING ADDRESS(ES):

USD 458  
2008 N 155<sup>th</sup> Street  
Basehor, KS 66007

## REQUEST FOR PETITIONING

We/I, the undersigned, request that the attorneys of Stumbo Hanson, LLP direct a Petition to the Board of County Commissioners of Leavenworth County, Kansas, such Petition seeking attachment of our land to the territory of Rural Water District No. 7, Leavenworth County, Kansas.

SIGNATURE(S) OF PETITIONER(S):

  
CHEYENNE CROSSING LAND  
DEVELOPMENT, LLC

BY: Joe F. Jenkins, II, MEMBER  
(Print)

7-30-2024  
Date

QUICK REFERENCE ID:

R25182

PROPERTY ADDRESS:

00000 Stillwell Road  
Bonner Springs, KS 66012

OWNER MAILING ADDRESS(ES):

Cheyenne Crossing Land Development, LLC  
18701 Hemphill Rd  
Tonganoxie, KS 66086

## REQUEST FOR PETITIONING

We/I, the undersigned, request that the attorneys of Stumbo Hanson, LLP direct a Petition to the Board of County Commissioners of Leavenworth County, Kansas, such Petition seeking attachment of our land to the territory of Rural Water District No. 7, Leavenworth County, Kansas.

SIGNATURE(S) OF PETITIONER(S):

  
\_\_\_\_\_  
JOE F. JENKINS, II, LIVING TRUST DATED  
DECEMBER 26, 2014

BY: JOE F. JENKINS, II, TRUSTEE  
(Print)

7-30-2024  
Date

QUICK REFERENCE ID:

R25178

PROPERTY ADDRESS:

18462 Stillwell Rd.  
Linwood, KS 66052

OWNER MAILING ADDRESS(ES):

Joe F. Jenkins II Living Trust  
18701 Hemphill Rd  
Tonganoxie, KS 66086



## REQUEST FOR PETITIONING

We/I, the undersigned, request that the attorneys of Stumbo Hanson, LLP direct a Petition to the Board of County Commissioners of Leavenworth County, Kansas, such Petition seeking attachment of our land to the territory of Rural Water District No. 7, Leavenworth County, Kansas.

SIGNATURE(S) OF PETITIONER(S):

  
JANET J. JENKINS LIVING TRUST DATED  
DECEMBER 26, 2014

BY: JOFF. JENKINS, II, TRUSTEE  
(Print)

7-30-2024  
Date

QUICK REFERENCE ID:

R25177

PROPERTY ADDRESS:

18701 Hemphill Rd  
Tonganoxie, KS 66086

OWNER MAILING ADDRESS(ES):

Janet J. Jenkins Living Trust  
11490 Osprey Landing Way  
Fort Myers, FL 33908

## REQUEST FOR PETITIONING

We/I, the undersigned, request that the attorneys of Stumbo Hanson, LLP direct a Petition to the Board of County Commissioners of Leavenworth County, Kansas, such Petition seeking attachment of our land to the territory of Rural Water District No. 7, Leavenworth County, Kansas.

SIGNATURE(S) OF PETITIONER(S):

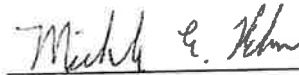

MICHALE E. REHM

7-31-2024

Date

QUICK REFERENCE ID:

R25158

PROPERTY ADDRESS:

18075 Metro Ave.  
Tonganoxie, KS 66086

OWNER MAILING ADDRESS(ES):

Michale E. Rehm  
18075 Metro Ave.  
Tonganoxie, KS 66086

## REQUEST FOR PETITIONING

We/I, the undersigned, request that the attorneys of Stumbo Hanson, LLP direct a Petition to the Board of County Commissioners of Leavenworth County, Kansas, such Petition seeking attachment of our land to the territory of Rural Water District No. 7, Leavenworth County, Kansas.

SIGNATURE(S) OF PETITIONER(S):

  
\_\_\_\_\_  
JAMES STAFFORD

8-5-24

Date

  
\_\_\_\_\_  
KATHRYN E. STAFFORD

8.5.2024

Date

QUICK REFERENCE ID:

R307731

PROPERTY ADDRESS:

15457 174<sup>th</sup> Street  
Bonner Springs, KS 66012

OWNER MAILING ADDRESS(ES):

James and Kathryn Stafford  
15457 174<sup>th</sup> Street  
Bonner Springs, KS 66012

## REQUEST FOR PETITIONING

We/I, the undersigned, request that the attorneys of Stumbo Hanson, LLP direct a  
Petition to the Board of County Commissioners of Leavenworth County, Kansas, such  
Petition seeking attachment of our land to the territory of Rural Water District No. 7,  
Leavenworth County, Kansas.

SIGNATURE(S) OF PETITIONER(S):

  
RJ BREIDENTHAL, JR

8/5/24  
Date

  
CONSTANCE BREIDENTHAL

8/5/24  
Date

QUICK REFERENCE ID:

R25180

PROPERTY ADDRESS:

17649 Hemphill Rd.  
Bonner Springs, KS 66012

OWNER MAILING ADDRESS(ES):

RJ Breidenthal, Jr. and Constance Breidenthal  
17649 Hemphill Rd.  
Bonner Springs, KS 66012

## REQUEST FOR PETITIONING

We/I, the undersigned, request that the attorneys of Stumbo Hanson, LLP direct a Petition to the Board of County Commissioners of Leavenworth County, Kansas, such Petition seeking attachment of our land to the territory of Rural Water District No. 7, Leavenworth County, Kansas.

SIGNATURE(S) OF PETITIONER(S):

  
RJ BREIDENTHAL, JR

8/24  
Date

  
CONSTANCE BREIDENTHAL

8/5/24  
Date

QUICK REFERENCE ID:

R25181

PROPERTY ADDRESS:

15568 182<sup>nd</sup> Street  
Bonner Springs, KS 66012

OWNER MAILING ADDRESS(ES):

RJ Breidenthal, Jr. and Constance Breidenthal  
17649 Hemphill Rd.  
Bonner Springs, KS 66012

## REQUEST FOR PETITIONING

We/I, the undersigned, request that the attorneys of Stumbo Hanson, LLP direct a Petition to the Board of County Commissioners of Leavenworth County, Kansas, such Petition seeking attachment of our land to the territory of Rural Water District No. 7, Leavenworth County, Kansas.

SIGNATURE(S) OF PETITIONER(S):

  
RJ BREIDENTHAL, JR

8/5/24  
Date

  
CONSTANCE BREIDENTHAL

8/5/24  
Date

QUICK REFERENCE ID:

R25160

PROPERTY ADDRESS:

17998 Hemphill Rd.  
Bonner Springs, KS 66012

OWNER MAILING ADDRESS(ES):

RJ Breidenthal, Jr. and Constance Breidenthal  
17649 Hemphill Rd.  
Bonner Springs, KS 66012

## REQUEST FOR PETITIONING

We/I, the undersigned, request that the attorneys of Stumbo Hanson, LLP direct a Petition to the Board of County Commissioners of Leavenworth County, Kansas, such Petition seeking attachment of our land to the territory of Rural Water District No. 7, Leavenworth County, Kansas.

SIGNATURE(S) OF PETITIONER(S):

  
RJ BREIDENTHAL, JR

8/5/24  
Date

  
CONSTANCE BREIDENTHAL

8/5/24  
Date

QUICK REFERENCE ID:

R25179

PROPERTY ADDRESS:

00000 174<sup>TH</sup> Street  
Bonner Springs, KS 66012

OWNER MAILING ADDRESS(ES):

RJ Breidenthal, Jr. and Constance Breidenthal  
17649 Hemphill Rd.  
Bonner Springs, KS 66012

## REQUEST FOR PETITIONING

We/I, the undersigned, request that the attorneys of Stumbo Hanson, LLP direct a Petition to the Board of County Commissioners of Leavenworth County, Kansas, such Petition seeking attachment of our land to the territory of Rural Water District No. 7, Leavenworth County, Kansas.

SIGNATURE(S) OF PETITIONER(S):

  
DANIEL K. OELSCHLAEGER

12-10-24  
Date

QUICK REFERENCE ID:

R25172

PROPERTY ADDRESS:

18590 Hemphill Rd.  
Tonganoxie, KS 66086

OWNER MAILING ADDRESS(ES):

Daniel K. Oelschlaeger  
18735 Metro Ave.  
Tonganoxie, KS 66086



## REQUEST FOR PETITIONING

We/I, the undersigned, request that the attorneys of Stumbo Hanson, LLP direct a Petition to the Board of County Commissioners of Leavenworth County, Kansas, such Petition seeking attachment of our land to the territory of Rural Water District No. 7, Leavenworth County, Kansas.

SIGNATURE(S) OF PETITIONER(S):

Betty L. Lingenfelter  
GEORGE C. LINGENFELSER AND BETTY L.  
LINGENFELSER REVOCABLE TRUST DATED  
MAY 16, 2014  
George C. Lingenfelter  
BY: George C. Lingenfelter TRUSTEE  
George (Print)

12-16-2024  
Date

QUICK REFERENCE ID:

R25157

PROPERTY ADDRESS:

16158 182<sup>ND</sup> Street  
Tonganoxie, KS 66086

OWNER MAILING ADDRESS(ES):

George and Betty Lingenfelter Revocable Trust  
16158 182<sup>ND</sup> Street  
Tonganoxie, KS 66086

## REQUEST FOR PETITIONING

We/I, the undersigned, request that the attorneys of Stumbo Hanson, LLP direct a Petition to the Board of County Commissioners of Leavenworth County, Kansas, such Petition seeking attachment of our land to the territory of Rural Water District No. 7, Leavenworth County, Kansas.

SIGNATURE(S) OF PETITIONER(S):

  
GEORGE L. LINGENFELSER TRUST

BY: George L. Lingenfelter TRUSTEE  
(Print)

1-15-25  
Date

QUICK REFERENCE ID:

R25170

PROPERTY ADDRESS:

00000 182<sup>nd</sup> Street  
Tonganoxie, KS 66086

OWNER MAILING ADDRESS(ES):

George L. Lingenfelter Trust  
15964 154<sup>th</sup> Street  
Bonner Springs, KS 66012

## REQUEST FOR PETITIONING

We/I, the undersigned, request that the attorneys of Stumbo Hanson, LLP direct a Petition to the Board of County Commissioners of Leavenworth County, Kansas, such Petition seeking attachment of our land to the territory of Rural Water District No. 7, Leavenworth County, Kansas.

SIGNATURE(S) OF PETITIONER(S):

  
BLACKTHORN LAND & TRADING, LLC

BY: Todd Banks, MEMBER  
(Print)

2/12/25  
Date

QUICK REFERENCE ID:

R27891

PROPERTY ADDRESS:

00000 Hemphill Rd.  
Tonganoxie, KS 66086

OWNER MAILING ADDRESS(ES):

Blackthorn Land & Trading, LLC  
11109 Buena Vista St  
Leawood, KS 66211

## REQUEST FOR PETITIONING

We/I, the undersigned, request that the attorneys of Stumbo Hanson, LLP direct a Petition to the Board of County Commissioners of Leavenworth County, Kansas, such Petition seeking attachment of our land to the territory of Rural Water District No. 7, Leavenworth County, Kansas.

SIGNATURE(S) OF PETITIONER(S):

  
BLACKTHORN LAND & TRADING, LLC

BY: Todd Banks, MEMBER  
(Print)

2/12/20  
Date

QUICK REFERENCE ID:

R27890

PROPERTY ADDRESS:

00000 Hemphill Rd.  
Tonganoxie, KS 66086

OWNER MAILING ADDRESS(ES):

Blackthorn Land & Trading, LLC  
11109 Bucna Vista St  
Leawood, KS 66211

## REQUEST FOR PETITIONING

We/I, the undersigned, request that the attorneys of Stumbo Hanson, LLP direct a Petition to the Board of County Commissioners of Leavenworth County, Kansas, such Petition seeking attachment of our land to the territory of Rural Water District No. 7, Leavenworth County, Kansas.

SIGNATURE(S) OF PETITIONER(S):

  
BLACKTHORN LAND & TRADING, LLC

BY: Todd Banks, MEMBER  
(Print)

2/12/25  
Date

QUICK REFERENCE ID:

R27939

PROPERTY ADDRESS:

00000 Hemphill Rd.  
Linwood, KS 66052

OWNER MAILING ADDRESS(ES):

Blackthorn Land & Trading, LLC  
11109 Buena Vista St  
Leawood, KS 66211

## REQUEST FOR PETITIONING

We/I, the undersigned, request that the attorneys of Stumbo Hanson, LLP direct a Petition to the Board of County Commissioners of Leavenworth County, Kansas, such Petition seeking attachment of our land to the territory of Rural Water District No. 7, Leavenworth County, Kansas.

SIGNATURE(S) OF PETITIONER(S):

  
BLACKTHORN LAND & TRADING, LLC

BY: Todd Banks, MEMBER  
(Print)

2/12/25  
Date

QUICK REFERENCE ID:

R27938

PROPERTY ADDRESS:

00000 Hemphill Rd.  
Linwood, KS 66052

OWNER MAILING ADDRESS(ES):

Blackthorn Land & Trading, LLC  
11109 Buena Vista St  
Leawood, KS 66211

## **EXHIBIT “C”**

### **I. BOUNDARY OF AREA TO BE ATTACHED IN LEAVENWORTH COUNTY**

A parcel of land in Leavenworth County, being more fully described as follows:

Beginning at the South Quarter Corner of Section 29, Township 11 South, Range 22 East of the 6th P.M., Leavenworth County, Kansas;

Thence North to the Southerly right of way of Kansas Turnpike Authority Interstate 70 (KTA I-70);

Thence Southwesterly along said Southerly right of way line of KTA I-70 to the intersection of the center line of Stranger Creek;

Thence Southerly along the meandering center line of said Stranger Creek to the South line of Section 25, Township 11 South, Range 21 East;

Thence East along the South line of said Section 25 and the South line of Section 29 and 30, Township 11 South, Range 22 East to the point of beginning.

### **II. INDIVIDUAL PARCELS TO BE ATTACHED**

- 1. Blackthorn Land and Trading, LLC (Quick Reference ID: R303171)**
- 2. Blackthorn Land and Trading, LLC (Quick Reference ID: R303173)**
- 3. Frances L. Oelschlaeger Revocable Living Trust Dated March 5, 1997 (Quick Reference ID: R25171)**
- 4. George L. Lingenfelser Trust (Quick Reference ID: R25170)**
- 5. Jon and Megan Lingenfelser (Quick Reference ID: R307182)**
- 6. Sarah R. Frederick Revocable Trust U/T/A Dated February 11, 2022 (Quick Reference ID: R25175)**
- 7. Daniel K. Oelschlaeger (Quick Reference ID: R25172)**

- 8. Craig and Kelly Owsley (Quick Reference ID: R25174)**
- 9. Blackthorn Land and Trading, LLC (Quick Reference ID: R27891)**
- 10. Blackthorn Land and Trading, LLC (Quick Reference ID: R27890)**
- 11. Blackthorn Land and Trading, LLC (Quick Reference ID: R27939)**
- 12. Blackthorn Land and Trading, LLC (Quick Reference ID: R27938)**
- 13. Kelly L. Owsley Trust Dated October 11, 2006 (Quick Reference ID: R27937)**
- 14. Swallow Tail, LLC (Quick Reference ID: R27950)**
- 15. Swallow Tail, LLC (Quick Reference ID: R27948)**
- 16. Paul A. Klamet (Quick Reference ID: R27947)**
- 17. Paul A. Klamet (Quick Reference ID: R27946)**
- 18. Flick Family Irrevocable Trust Dated December 3, 2012 (Quick Reference ID: R307371)**
- 19. Janet Jenkins Living Trust Dated December 26, 2014 (Quick Reference ID: R25177)**
- 20. Joe F. Jenkins II Living Trust Dated December 26, 2014 (Quick Reference ID: R25178)**
- 21. John and Susan Schlag (Quick Reference ID: R25183)**
- 22. Cheyenne Crossing Land Development, LLC (Quick Reference ID: R25182)**
- 23. USD #458 (Quick Reference ID: R308348)**
- 24. Mary Sue Schlagel and Matthew Geron (Quick Reference ID: R25184)**
- 25. RJ Breidenthal, Jr. and Constance Breidenthal (Quick Reference ID: R25179)**
- 26. RJ Breidenthal, Jr. and Constance Breidenthal (Quick Reference ID: R25180)**
- 27. RJ Breidenthal, Jr. and Constance Breidenthal (Quick Reference ID: R25181)**



- 28. Sarah R. Frederick Revocable Trust U/T/A Dated February 11, 2022 (Quick Reference ID: R25176)**
- 29. RJ Breidenthal, Jr. and Constance Breidenthal (Quick Reference ID: R25160)**
- 30. Mike and Angela Oelschlaeger (Quick Reference ID: R25159)**
- 31. George C. Lingenfelser and Betty L. Lingenfelser Revocable Trust Dated May 16, 2014 (Quick Reference ID: R25157)**
- 32. Michael E. Rehm (Quick Reference ID: R25158)**

## REQUEST FOR PETITIONING

We/I, the undersigned, request that the attorneys of Stumbo Hanson, LLP direct a Petition to the Board of County Commissioners of Leavenworth County, Kansas, such Petition seeking attachment of our land to the territory of Rural Water District No. 7, Leavenworth County, Kansas.

SIGNATURE(S) OF PETITIONER(S):

  
THE TONY M. BAKKER LIVING TRUST

BY: Tony Bakker, TRUSTEE  
(Print)

8/12/2024  
Date

PARCEL ID:

965400

PROPERTY ADDRESS:

5625 S. 142<sup>ND</sup> Street  
Bonner Springs, KS 66012

OWNER MAILING ADDRESS(ES):

The Tony M. Bakker Living Trust  
8006 W 102<sup>ND</sup> Street  
Overland Park, KS 66212

# JOHNSON COUNTY GOVERNMENT REAL PROPERTY VALUE TAX SEARCH

Quick Map ID	Parcel ID	Owner	Original Address	2024 Appraised Value
R70677	965400	THE TONY M BAKKER LIVING TRUST	5625 S 142ND ST, BONNER SPRINGS, KS 66012	\$139,050

## 2024 GENERAL INFORMATION

Property Type	Farm Homestead
Description	9654, 519, T12, R23, ACRES 38.73, NW1/4 NWLY OF RIVER LS W 20FT; ALSO 18-12-23: S1/4 SW1/4 SW1/4 LS W 20FT; CONTG 40AC M/L
LBCS Description	Farming / ranch operation (with improvements)
Property ID	105-074-19-0-20-01-002.00-0
Parcel ID	965400
Class	Farm Homestead - F
Neighborhood	700
Taxing Unit Group	Delaware Township - 100
Book Page	2014R-00451

## 2024 OWNER INFORMATION

Owner Name	THE TONY M BAKKER LIVING TRUST
Mailing Address	8006 W 102ND ST OVERLAND PARK, KS 66212
Exemptions	-

## PROPERTY PHOTO



## MAP INFORMATION

Map	654
Map Section	G19
Parcel Map	<a href="#">View</a>
Quarter Section Parcel Map	<a href="#">View</a>
Plat Map	Not Available
Engineering Map	<a href="#">View</a>

## OTHER NAME ADDRESSES

NAME	ADDRESS
BAKKER, TONY M TRUST	8006 W 102ND TER, OVERLAND PARK, KS, 66212

## PROPERTY ADDRESSES

ADDRESS TYPE	ADDRESS
Primary Address	5625 S 142ND ST, Bonner Springs, KS 66012

## LOT INFORMATION

Dimensions			
Frontage: 0.0	Left: 0.0	Right: 0.0	Rear: 0.0
Deeded Acres: 0.0		Mapped Acres: 38.695	
		Mapped SQFT: 1,685,619	

## VALUE BREAKDOWN

YEAR	APPRAISED VALUE	ASSESSED VALUE	ADD'L INFO
2024	\$139,050	\$21,995	<a href="#">Details</a>

## RESIDENTIAL BUILDINGS

YEAR BUILT	MS BUILDING VALUE	RCNLD	MFLA	TOTAL AREA (SQ. FT)	ADD'L INFO
1945	\$93,395	\$56,040	576	676	<a href="#">Details</a>

## VALUE HISTORY

Expand/Collapse All

YEAR	APPRAISED VALUE	ASSESSED VALUE	ADD'L INFO
2023	\$129,080	\$21,081	<a href="#">Details</a>
2022	\$102,180	\$17,870	<a href="#">Details</a>
2021	\$86,270	\$15,767	<a href="#">Details</a>
2020	\$83,180	\$15,158	<a href="#">Details</a>
2019	\$80,300	\$14,772	<a href="#">Details</a>

## REQUEST FOR PETITIONING

We/I, the undersigned, request that the attorneys of Stumbo Hanson, LLP direct a Petition to the Board of County Commissioners of Leavenworth County, Kansas, such Petition seeking attachment of our land to the territory of Rural Water District No. 7, Leavenworth County, Kansas.

SIGNATURE(S) OF PETITIONER(S):

  
LITTLE KAW POINT, LLC

BY: Jason A. Bowman, MEMBER  
(Print)

8/1/24  
Date

PARCEL ID:

961200

PROPERTY ADDRESS:

3981 Loring Ln  
Bonner Springs, KS 66012

OWNER MAILING ADDRESS(ES):

Little Kaw Point, LLC  
14620 Archer Rd  
Bonner Springs, KS 66012

## UNIFIED GOVERNMENT REAL PROPERTY VALUATION REPORT

2024 Roll ID	Parcel ID	Owner	Property Address	2024 Appraised Value
R70654	961200	LITTLE KAW POINT LLC	3981 LORING LN. BONNER SPRINGS, KS 66012	\$2,410

## 2024 GENERAL INFORMATION

Property Type	Vacant
Description	9612, S6, T12, R23, ACRES 27.7, SE1/4 E OF RR RAW W OF RIVER CONTG 28AC
LBCS Description	Residential highest and best use
Property ID	105-073-06-0-40-01-001.00-0
Parcel ID	961200
Class	Vacant Lots - V
Neighborhood	700
Taxing Unit Group	Delaware Township - 100
Book Page	2023R-11337

## 2024 OWNER INFORMATION

Owner Name	LITTLE KAW POINT LLC
Mailing Address	14620 ARCHER RD BONNER SPRINGS, KS 66012

Exemptions -

## PROPERTY PHOTO



## MAP INFORMATION

Map	512
Map Section	G06
Parcel Map	<a href="#">View</a>
Quarter Section Parcel Map	<a href="#">View</a>
Plat Map	Not Available
Engineering Map	<a href="#">View</a>

## OTHER NAME ADDRESSES

NAME	ADDRESS
LITTLE KAW POINT LLC	14620 ARCHER RD , BONNER SPRINGS, KS, 66012

## PROPERTY ADDRESSES

ADDRESS TYPE	ADDRESS
Primary Address	3981 LORING LN, Bonner Springs, KS 66012
Secondary Address	03421 LORING LN, Bonner Springs, KS 66012

## LOT INFORMATION

Dimensions			
Frontage: 0.0	Left: 0.0	Right: 0.0	Rear: 0.0
Deeded Acres: 0.0	Mapped Acres: 27.895		Mapped SQFT: 1,215,109

## VALUE BREAKDOWN

YEAR	APPRAISED VALUE	ASSESSED VALUE	ADD'L INFO
2024	\$2,410	\$289	<a href="#">Details</a>

## VALUE HISTORY

[Expand/Collapse All](#)

YEAR	APPRAISED VALUE	ASSESSED VALUE	ADD'L INFO
2023	\$2,050	\$615	<a href="#">Details</a>
2022	\$2,030	\$609	<a href="#">Details</a>
2021	\$1,990	\$597	<a href="#">Details</a>
2020	\$1,960	\$588	<a href="#">Details</a>
2019	\$1,830	\$549	<a href="#">Details</a>

## REQUEST FOR PETITIONING

We/I, the undersigned, request that the attorneys of Stumbo Hanson, LLP direct a Petition to the Board of County Commissioners of Leavenworth County, Kansas, such Petition seeking attachment of our land to the territory of Rural Water District No. 7, Leavenworth County, Kansas.

SIGNATURE(S) OF PETITIONER(S):

  
DAVID FRANK LEE

  
Date

PARCEL ID:

965301

PROPERTY ADDRESS:

5505 S. 142<sup>ND</sup> Street  
Bonner Springs, KS 66012

OWNER MAILING ADDRESS(ES):

David Frank Lee  
218 Cornell Ave.  
Bonner Springs, KS 66012

2023 Parcel ID	2023 Parcel ID	Owner	Property Address	2023 Appraised Value
R70674	965301	LEE, DAVID FRANK	5505 S 142ND ST, BONNER SPRINGS, KS 66012	\$98,230

## 2023 GENERAL INFORMATION

Property Type	Farm Homesite
Description	9653, 518, T12, R23, ACRES 29.72, N 30AC OF SW1/4 SW1/4
LBCS Description	Farming / ranch operation (with Improvements)
Property ID	105-074-18-0-30-01-003.00-0
Parcel ID	965301
Class	Farm Homesite - F
Neighborhood	700
Taxing Unit Group	Delaware Township - 100
Book Page	2018R-13330

## 2023 OWNER INFORMATION

Owner Name	LEE, DAVID FRANK
Mailing Address	218 CORNELL AVE BONNER SPRINGS, KS 66012

Exemptions -

## PROPERTY PHOTO



## MAP INFORMATION

Map	653
Map Section	G18
Parcel Map	<a href="#">View</a>
Quarter Section Parcel Map	<a href="#">View</a>
Plat Map	Not Available
Engineering Map	<a href="#">View</a>

## OTHER NAME ADDRESSES

NAME	ADDRESS
LEE, DAVID FRANK	5505 S 142ND ST., BONNER SPRINGS, KS, 66012

## PROPERTY ADDRESSES

ADDRESS TYPE	ADDRESS
Primary Address	5505 S 142ND ST, Bonner Springs, KS 66012

## LOT INFORMATION

Dimensions			
Frontage: 0.00	Left: 0.00	Right: 0.00	Rear: 0.00
Deeded Acres: 0.0	Mapped Acres: 29.717		Mapped SQFT: 1,294,453

## VALUE BREAKDOWN

YEAR	APPRAISED VALUE	ASSESSED VALUE	ADD'L INFO
2024	\$98,230	\$17,114	<a href="#">Details</a>

## RESIDENTIAL BUILDINGS

YEAR BUILT	MS BUILDING VALUE	RCNLD	MFLA	TOTAL AREA (SQ. FT)	ADD'L INFO
1920	\$172,586	\$15,530	871	1,261	<a href="#">Details</a>

## VALUE HISTORY

[Expand/Collapse All](#)

YEAR	APPRAISED VALUE	ASSESSED VALUE	ADD'L INFO
2023	\$88,880	\$16,266	<a href="#">Details</a>
2022	\$77,390	\$14,888	<a href="#">Details</a>
2021	\$50,640	\$11,510	<a href="#">Details</a>
2020	\$48,750	\$10,985	<a href="#">Details</a>
2019	\$41,510	\$9,685	<a href="#">Details</a>

## REQUEST FOR PETITIONING

We/I, the undersigned, request that the attorneys of Stumbo Hanson, LLP direct a Petition to the Board of County Commissioners of Leavenworth County, Kansas, such Petition seeking attachment of our land to the territory of Rural Water District No. 7, Leavenworth County, Kansas.

SIGNATURE(S) OF PETITIONER(S):

James C. Kreider II  
MOO MESA, LLC

BY: JAMES C. KREIDER II, MEMBER  
(Print)

8-16-24  
Date

PARCEL ID:

961000

PROPERTY ADDRESS:

4669 Loring Ln  
Bonner Springs, KS 66012

OWNER MAILING ADDRESS(ES):

Moo Mesa LLC  
13900 Krieder Rd.  
Bonner Springs, KS 66012



# 2024 GENERAL INFORMATION

2024 Parcel ID	2024 Parcel ID	Owner	Address	2024 Appraised Value
R70669	961000	MOO MESA LLC	4669 LORING LN, BONNER SPRINGS, KS 66012	\$164,170

## 2024 GENERAL INFORMATION

Property Type	Agricultural Use
Description	9610, S7, T12, R23, ACRES 205.43, 73B W1/2 SE1/4 ALSO SW1/4 E OF UPRR R/W CONTG 175.60AC M/L
LBCS Description	Farming / ranch land (no Improvements)
Property ID	105-073-07-0-40-01-001-00-0
Parcel ID	961000
Class	Agricultural Use - A
Neighborhood	700
Taxing Unit Group	Delaware Township - 100
Book Page	5330-0513

## 2024 OWNER INFORMATION

Owner Name	MOO MESA LLC
Mailing Address	13900 KRIEDER RD BONNER SPRINGS, KS 66012
Exemptions	-

## PROPERTY PHOTO



## MAP INFORMATION

Map	610
Map Section	G07
Parcel Map	<a href="#">View</a>
Quarter Section Parcel Map	<a href="#">View</a>
Plat Map	Not Available
Engineering Map	<a href="#">View</a>

## OTHER NAME ADDRESSES

NAME	ADDRESS
MOO MESA LLC	13900 KRIEDER RD , BONNER SPRINGS, KS, 66012

## PROPERTY ADDRESSES

ADDRESS TYPE	ADDRESS
Primary Address	4669 LORING LN, Bonner Springs, KS 66012

## LOT INFORMATION

Dimensions			
Frontage: 0.00	Left: 0.00	Right: 0.00	Rear: 0.00
Deeded Acres: 0.0	Mapped Acres: 205.389	Mapped SQFT: 8,946,754	

## VALUE BREAKDOWN

YEAR	APPRAISED VALUE	ASSESSED VALUE	ADD'L INFO
2024	\$164,170	\$49,251	<a href="#">Details</a>

## VALUE HISTORY

Expand/Collapse All

YEAR	APPRAISED VALUE	ASSESSED VALUE	ADD'L INFO
2023	\$176,310	\$52,893	<a href="#">Details</a>
2022	\$175,420	\$52,626	<a href="#">Details</a>
2021	\$162,480	\$48,744	<a href="#">Details</a>
2020	\$148,690	\$44,607	<a href="#">Details</a>
2019	\$138,960	\$41,688	<a href="#">Details</a>

## REQUEST FOR PETITIONING

We/I, the undersigned, request that the attorneys of Stumbo Hanson, LLP direct a Petition to the Board of County Commissioners of Leavenworth County, Kansas, such Petition seeking attachment of our land to the territory of Rural Water District No. 7, Leavenworth County, Kansas.

SIGNATURE(S) OF PETITIONER(S):

*James C. Kreider II, sole member*  
MOO MESA, LLC

BY: JAMES C. KREIDER II MEMBER  
(Print)

8-16-24  
Date

PARCEL ID:

961100

PROPERTY ADDRESS:

4159 Loring Ln  
Bonner Springs, KS 66012

OWNER MAILING ADDRESS(ES):

Moo Mesa LLC  
13900 Krieder Rd.  
Bonner Springs, KS 66012

Parcel ID	Parcel ID	Owner	Property Address	2024 Appraised Value
R70658	961100	MOO MESA LLC	4159 LORING LN, BONNER SPRINGS, KS 66012	\$78,110

#### 2024 GENERAL INFORMATION

Property Type	Agricultural Use
Description	SEC-07 TWP-12 RNG-23, S7, T12, R23, ACRES 87.340000, 73A BEG 981.90FT E OF NW COR NE1/4; S10E-442.10FT, S08E- 395.23FT, S09E-176.12FT, S01E- 311.4FT, S05W-395.22FT S02W- 223.89FT, S02E-267.81, S04W- 230.50FT, S03E-238.89 TO S LN NE1/4, W 1831.21FT TO CEN SEC, W 154.04FT TO E LN U P RR, N1
LBCS Description	Farming / ranch land (no improvements)
Property ID	105-073-07-0-10-01-001-00-0
Parcel ID	961100
Class	Agricultural Use - A
Neighborhood	700
Taking Unit Group	Delaware Township - 100
Book Page	5330-0513

#### 2024 OWNER INFORMATION

Owner Name	MOO MESA LLC
Mailing Address	13900 KRIEDER RD BONNER SPRINGS, KS 66012
Exemptions	-

#### PROPERTY PHOTO



#### MAP INFORMATION

Map	611
Map Section	G07
Parcel Map	<a href="#">View</a>
Quarter Section Parcel Map	<a href="#">View</a>
Plat Map	Not Available
Engineering Map	<a href="#">View</a>

#### OTHER NAME ADDRESSES

NAME	ADDRESS
MOO MESA LLC	13900 KRIEDER RD , BONNER SPRINGS, KS, 66012

#### PROPERTY ADDRESSES

ADDRESS TYPE	ADDRESS
Primary Address	4159 LORING LN, Bonner Springs, KS 66012

#### LOT INFORMATION

Dimensions			
Frontage: 0.00	Left: 0.00	Right: 0.00	Rear: 0.00
Deeded Acres: 0.0	Mapped Acres: 102.598	Mapped SQFT: 4,469,172	

#### VALUE BREAKDOWN

YEAR	APPRAISED VALUE	ASSESSED VALUE	ADD'L INFO
2024	\$78,110	\$23,433	<a href="#">Details</a>

#### VALUE HISTORY

⌵ Expand/Collapse All

YEAR	APPRAISED VALUE	ASSESSED VALUE	ADD'L INFO
2023	\$83,380	\$25,014	<a href="#">Details</a>
2022	\$82,960	\$24,888	<a href="#">Details</a>
2021	\$74,180	\$22,254	<a href="#">Details</a>
2020	\$69,900	\$20,970	<a href="#">Details</a>
2019	\$65,280	\$19,584	<a href="#">Details</a>

## REQUEST FOR PETITIONING

We/I, the undersigned, request that the attorneys of Stumbo Hanson, LLP direct a Petition to the Board of County Commissioners of Leavenworth County, Kansas, such Petition seeking attachment of our land to the territory of Rural Water District No. 7, Leavenworth County, Kansas.

SIGNATURE(S) OF PETITIONER(S):



THE MELVIN E. THENO LIVING TRUST

BY: Melvin Theno, TRUSTEE  
(Print)

8/24/24

Date

PARCEL ID:

965300

PROPERTY ADDRESS:

5201 S. 142<sup>ND</sup> Street  
Bonner Springs, KS 66012

OWNER MAILING ADDRESS(ES):

The Melvin E. Theno Living Trust  
22219 163<sup>rd</sup> Street  
Bashor, KS 66007

# 2024 GENERAL INFORMATION

Parcel ID	Parcel ID	Owner	Property Address	2024 Appraised Value
R70673	965300	THENO, MELVIN E	5201 S 142ND ST, BONNER SPRINGS, KS 66012	\$103,550

## 2024 GENERAL INFORMATION

Property Type	Agricultural Use
Description	SEC-18 TWP-12 RNG-23, S18, T12, R23, ACRES 88.250000, 80 N1/2 S1/2 85.00AC
LBCS Description	Farming / ranch land (with Ag improvements)
Property ID	105-074-18-0-30-01-001.00-0
Parcel ID	965300
Class	Agricultural Use - A
Neighborhood	700
Taxing Unit Group	Delaware Township - 100
Book Page	5647-0239

## 2024 OWNER INFORMATION

Owner Name	THENO, MELVIN E
Mailing Address	22219 163RD ST BASEHOR, KS 66007- 5172
Exemptions	-

## PROPERTY PHOTO



## MAP INFORMATION

Map	653
Map Section	G18
Parcel Map	<a href="#">View</a>
Quarter Section Parcel Map	<a href="#">View</a>
Plat Map	Not Available
Engineering Map	<a href="#">View</a>

## OTHER NAME ADDRESSES

NAME	ADDRESS
MELVIN E THENO LIVING TRUST	22219 163RD ST, BASEHOR, KS, 66007

## PROPERTY ADDRESSES

ADDRESS TYPE	ADDRESS
Primary Address	5201 S 142ND ST, Bonner Springs, KS 66012

## LOT INFORMATION

Dimensions			
Frontage: 0.00	Left: 0.00	Right: 0.00	Rear: 0.00
Deeded Acres: 0.0	Mapped Acres: 86.463	Mapped SQFT: 3,766,311	

## VALUE BREAKDOWN

YEAR	APPRAISED VALUE	ASSESSED VALUE	ADD'L INFO
2024	\$103,550	\$29,653	<a href="#">Details</a>

## VALUE HISTORY

[Expand/Collapse All](#)

YEAR	APPRAISED VALUE	ASSESSED VALUE	ADD'L INFO
2023	\$105,470	\$30,313	<a href="#">Details</a>
2022	\$101,330	\$29,251	<a href="#">Details</a>
2021	\$95,960	\$27,704	<a href="#">Details</a>
2020	\$92,550	\$26,639	<a href="#">Details</a>
2019	\$67,900	\$20,258	<a href="#">Details</a>

## **EXHIBIT "E"**

### **I. BOUNDARY OF AREAS TO BE ATTACHED IN WYANDOTTE COUNTY**

A parcel of land in Wyandotte County, Kansas, being more fully described as follows:

Beginning at the West Quarter Corner of Section 18, Township 12 South, Range 23 East of the 6th P.M., Wyandotte County, Kansas;

Thence East along the center section line of Section 18 to the Westerly Bank of the Kansas River;

Thence Southerly along the meandering Bank of the Kansas River to the West line of Section 19, Township 12 South, Range 23 East;

Thence North along said West line to the point of beginning.

And

A parcel of land in Wyandotte County, Kansas, being more fully described as follows:

Beginning at the Southwest corner of Section 7, Township 12 South, Range 23 East of the 6th P.M., Wyandotte County, Kansas;

Thence Northeasterly along the Easterly right of way line of the Union Pacific Railway to a point on the East line of Section 6, Township 12 South, Range 23 East, Wyandotte County, Kansas, said line also being the City Limits of Bonner Springs, Kansas;

Thence South along said East line of said Section 6 and the City Limits of Bonner Springs to the Westerly Bank of the Kansas River;

Thence Southerly along the meandering West Bank of the Kansas River to the South line of Section 7, Township 12 South, Range 23 East;

Thence West along said South line of Section 7 to the point of beginning.

## **II. INDIVIDUAL PARCELS TO BE ATTACHED**

- 1. Tony M. Bakker Living Trust (Parcel ID: 965400)**
- 2. Orrick Acres, LLC (Parcel ID: 965302)**
- 3. David Frank Lee (Parcel ID: 965301)**
- 4. Melvin E. Theno Living Trust (Parcel ID: 965300)**
- 5. Moo Mesa, LLC (Parcel ID: 961000)**
- 6. Moo Mesa, LLC (Parcel ID: 961100)**
- 7. Union Pacific Railroad Company (Parcel ID: 961202)**
- 8. Little Kaw Point, LLC (Parcel ID: 961200)**
- 9. Sandbar Development, LLC (Parcel ID: 960600)**
- 10. Union Pacific Railroad Company (Parcel ID: 960602)**

BEFORE THE BOARD OF COUNTY COMMISSIONERS OF  
LEAVENWORTH COUNTY, KANSAS

IN THE MATTER OF THE PETITION FOR THE  
ATTACHMENT OF LANDS TO RURAL WATER  
DISTRICT NO. 7, LEAVENWORTH COUNTY, KANSAS

**NOTICE OF HEARING ON PETITION TO ATTACH LANDS  
TO RURAL WATER DISTRICT NO. 7  
LEAVENWORTH COUNTY, KANSAS**

To whom it may concern and especially to the owners of land located within the boundaries of the proposed attachment to Rural Water District No. 7, Leavenworth County, Kansas, hereinafter described.

You are hereby notified that a petition, addressed to the Board of County Commissioners of Leavenworth County, Kansas, has been filed in my office praying for an order attaching the land described below to Rural Water District No. 7, Leavenworth County, Kansas, under the authority of Kansas Statutes Annotated 82a-612 et seq., as amended, to-wit:

The boundaries of the land proposed to be attached to Rural Water District No. 7, Leavenworth County, Kansas, are described by metes and bounds as follows, all of such land being in Leavenworth County and Wyandotte County, Kansas:

See Exhibit "A", attached hereto.

A hearing on said petition will be held on Wednesday, the 7th day of May, 2025 at 9:00 a.m. in the Commission Chambers of the Leavenworth County Courthouse, Room 225, Leavenworth, Kansas, at which time and place all owners of land within said boundaries may appear and be heard.

A rural water district shall have no power or authority to levy any taxes whatsoever.

Grant Keppler  
County Clerk

4/24/2025  
Date



A parcel of land in Leavenworth and Wyandotte County, Kansas, being more fully described as follows:

Beginning at the Northwest corner of Section 6, Township 12 South, Range 23 East, said point along being on the Leavenworth-Wyandotte County Line;

Thence North along the said Leavenworth-Wyandotte County Line to the Southerly right of way of Kansas Turnpike Authority Interstate 70 (KTA I-70);

Thence Southwesterly along said Southerly right of way line of KTA I-70 to the intersection of the center line of Stranger Creek;

Thence Southerly along the meandering center line of said Stranger Creek to the projected Northerly Bank of the Kansas River;

Thence Eastwardly along the meandering Northerly Bank of the Kansas River to the point on the East line of Section 6, Township 12 South, Range 23 East, Wyandotte County, Kansas, said line also being the City Limits of Bonner Springs, Kansas;

Thence North along said East line to the Southerly right of way line of Union Pacific Railway and along said city limits line;

Thence Northeasterly along said Southerly right of way and City Limits line to the North line of Section 5, Township 12 South, Range 23;

Thence West along said North line of Sections 5 and 6, Township 12 South, Range 23, and along the said city limits to the Northeast corner of the Northwest Quarter of said Section 6;

Thence South along the East line of said Northwest Quarter and said city limits for an approximate distance of 900 feet to the south line of said city limits;

Thence West along said South line of city limits to the West line of said Section 6;

Thence North along said West line for an approximate distance of 900 feet to the point of beginning.

LV 1

A parcel of land in Leavenworth County, being more fully described as follows:

Beginning at the South Quarter Corner of Section 29, Township 11 South, Range 22 East of the 6<sup>th</sup> P.M., Leavenworth County, Kansas;

Thence North to the Southerly right of way of Kansas Turnpike Authority Interstate 70 (KTA I-70);

Thence Southwesterly along said Southerly right of way line of KTA I-70 to the intersection of the center line of Stranger Creek;

Thence Southerly along the meandering center line of said Stranger Creek to the South line of Section 25, Township 11 South, Range 21 East;

Thence East along the South line of said Section 25 and the South line of Section 29 and 30, Township 11 South, Range 22 East to the point of beginning.

#### WYCO 1

A parcel of land in Wyandotte County, Kansas, being more fully described as follows:

Beginning at the West Quarter Corner of Section 18, Township 12 South, Range 23 East of the 6<sup>th</sup> P.M., Wyandotte County, Kansas;

Thence East along the center section line of Section 18 to the Westerly Bank of the Kansas River;

Thence Southerly along the meandering Bank of the Kansas River to the West line of Section 19, Township 12 South, Range 23 East;

Thence North along said West line to the point of beginning.

#### WYCO 2

A parcel of land in Wyandotte County, Kansas, being more fully described as follows:

Beginning at the Southwest corner of Section 7, Township 12 South, Range 23 East of the 6<sup>th</sup> P.M., Wyandotte County, Kansas;

Thence Northeasterly along the Easterly right of way line of the Union Pacific Railway to a point on the East line of Section 6, Township 12 South, Range 23 East, Wyandotte County, Kansas, said line also being the City Limits of Bonner Springs, Kansas;

Thence South along said East line of said Section 6 and the City Limits of Bonner Springs to the Westerly Bank of the Kansas River;

Thence Southerly along the meandering West Bank of the Kansas River to the South line of Section 7, Township 12 South, Range 23 East;

Thence West along said South line of Section 7 to the point of beginning.

**BOARD ORDER 2025-5**

**THE BOARD OF COUNTY COMMISSIONERS OF LEAVENWORTH COUNTY,  
KANSAS ORDER FOR ATTACHMENT IN THE MATTER OF THE PETITION FOR  
THE ATTACHMENT OF LANDS TO RURAL WATER DISTRICT NO. 7,  
LEAVENWORTH COUNTY, KANSAS**

**WHEREAS**, on this 7th day of May, 2025, this matter came before the Board of County Commissioners, Leavenworth County, Kansas, for a public hearing; and

**WHEREAS**, the Board then reviewed the Petition for Attachment of Lands to Rural Water District No. 7, Leavenworth County, Kansas, the exhibits to that Petition, the Notice of Hearing, and heard the testimony of those present who spoke on the Petition; and

**WHEREAS**, based on this evidence, the Board of County Commissioners finds that proper notice of this hearing has been given as required by K.S.A. 82a-623; and

**WHEREAS**, based on this evidence, the Board of County Commissioners finds that the statements contained in the Petition are true; and

**WHEREAS**, based on this evidence, the Board of County Commissioners finds that no objections have been made by any of the Directors of Rural Water District No. 7, Leavenworth County, Kansas, to the proposed attachment.

**NOW, THEREFORE, THE BOARD OF COUNTY COMMISSIONERS OF LEAVENWORTH COUNTY, KANSAS, SITTING IN REGULAR SESSION, DOES HEREBY ORDER:**

1. That the Petition for Attachment of Lands to Rural Water District No. 7, Leavenworth County, Kansas, filed on April 7, 2025, is approved; and
2. That the description of the new territory attached to said District, in Leavenworth and Wyandotte Counties, is described by metes and bounds as follows:

See Exhibit "A", attached hereto.

ADOPTED THIS 7<sup>TH</sup> DAY OF MAY, 2025.

**BOARD OF COUNTY COMMISSIONERS  
OF LEAVENWORTH COUNTY, KANSAS**

---

**Mike Smith, Chair**

---

**Vanessa Reid, Commissioner**

---

**Willie Dove, Commissioner**

---

**Jeff Culbertson, Commissioner**

---

**Mike Stieben, Commissioner**

**ATTEST:**

---

**Fran Keppler, COUNTY CLERK**

# Leavenworth County Request for Board Action

**Date:** April 30, 2025

**To:** Board of County Commissioners

**Cc:** Mark Loughry, County Administrator

**From:** Misty Brown, County Counselor

**Department Head Approval:** N/A

**Additional Reviews as needed:**

**Budget Review** ☐ **Administrator Review** ☐ **Legal Review** ☐

---

---

**Action Requested:** Consideration of an Agreement that terminates the lease at 711 Marshall, Leavenworth, KS (Cushing Building).

**Recommendation:** Approve the Agreement and authorize the Chair to execute the agreement.

**Analysis:** On April 14, 2021, the County entered into a five-year lease agreement with Signature Behavioral Hospital Operations, LLC (“Tenant”) for premises located at 711 Marshall Street. Although the Tenant initiated modifications to the space, they ultimately did not occupy the premises or complete the proposed renovations. The Tenant has expressed a desire to terminate the lease effective May 8, 2025 and has proposed a settlement payment of \$2,200,000.00 to the County to resolve all claims related to the lease.

**Alternatives:** Table, Deny, or Approve.

**Budgetary Impact:**

- ☒ Not Applicable
- ☐ Budgeted item with available funds
- ☐ Non-Budgeted item with available funds through prioritization
- ☐ Non-Budgeted item with additional funds requested

**Total Amount Requested:**

**Additional Attachments:**

Lease Termination Agreement

## Lease Termination Agreement

This Lease Termination Agreement (the “**Agreement**”) is made by and between County of Leavenworth, Kansas (“**Landlord**”), and Signature Behavioral Hospital Operations, LLC (“**Tenant**”) to be effective as of April 30, 2025.

### Recitals

A. Landlord and Tenant are parties to that certain Lease Agreement with an Effective Date of April 14, 2021 (the “**Lease**”), wherein Landlord leases to Tenant approximately 15,077 square feet of space located on the first and third floors in that certain building located at 711 Marshall Street, Leavenworth, Kansas 66048 (the “**Premises**”).

B. The parties desire to terminate the Lease and to hereby end the Lease Term thereby created.

**Now, therefore**, in consideration of the mutual covenants contained herein and other good and valuable consideration, the receipt and sufficiency of which is acknowledged, the parties mutually covenant and agree as follows:

1. **Termination Date.** The Lease and tenancy thereunder shall remain in full force and effect until 11:59 p.m. local time on May 8, 2025 (“**Termination Date**”), at which time the Lease and corresponding Lease Term shall end and terminate.

2. **Consideration.** For and in consideration of the early termination and cancellation of the Lease, Tenant agrees to pay Landlord in lawful U.S. currency, on or before the Termination Date, a lease termination payment equal to \$2,200,000.00 (the “**Termination Payment**”). Both Landlord and Tenant acknowledge and agree that the Termination Payment is being paid in consideration of the early termination and cancellation of the Lease and in full settlement of Tenant’s and Landlord’s obligations thereunder.

3. **Surrender.** On or before the Termination Date, Tenant shall surrender possession of the Premises unto the Landlord, its successors and assigns, subject to the terms and conditions set forth herein. Landlord shall unconditionally accept surrender of the Lease and the Premises in its “**AS IS**” condition, and Tenant shall have no further payment, restoration, removal of property, or other obligations in connection with the Lease or the Premises.

4. **No Additional Rent.** Notwithstanding anything in the Lease to the contrary, there shall be no reconciliation of any additional Rent (including without limitation any common area operating and maintenance costs, real estate taxes, or insurance), and there shall be no rent or other amounts due from Tenant after the date hereof.

5. **Release.** As of the Termination Date, each of the parties shall and hereby does mutually release and discharge each other, their successors and assigns, from its respective obligations and liabilities (financial or otherwise) under the Lease, whether to be kept, observed or performed in the past, at present or in the future, including, but not limited to, any requirement on the part of the Tenant to perform any improvement or restoration of the Premises.

6. **Landlord's Representations.** Landlord has not heretofore assigned, transferred, encumbered or otherwise disposed of Landlord's rights under the Lease, and no consent to this Agreement other than Landlord's consent is required to bind Landlord's interest.

7. **Entire Agreement.** This Agreement constitutes the entire agreement between the parties and shall be binding upon and inure to the benefit of the parties hereto and their respective heirs, executors, administrators successors and assigns. The provisions of the Agreement shall supersede all provisions of the Lease that are inconsistent herewith.

8. **Counterparts.** This Agreement may be executed in one or more counterparts, each of which shall be deemed an original hereof, but all of which shall constitute one and the same agreement.

9. **Capitalized Terms.** All terms in initial capital letters not otherwise defined herein shall have the meaning ascribed to them in the Lease.

10. **Authority.** Each party executing this Agreement hereby represents and warrants that such party has full right and authority to execute and deliver the Agreement and that each person signing on behalf of such party is authorized to do so.

11. **Applicable Law and Venue.** This Agreement is subject to, governed by, and construed according to the laws of the State of Kansas. Jurisdiction and venue of any suit in connection with the Agreement shall reside only in courts located in Leavenworth County, Kansas.

12. **Severability.** If a court of competent jurisdiction declares any part of this Agreement to be invalid, the balance of the agreement will remain valid and enforceable.

*(Signature Page to Follow)*

**In Witness Whereof**, the parties hereto have executed this Agreement to be effective as of the day and year first written above.

Landlord:

**County of Leavenworth Kansas**

By: \_\_\_\_\_

Print Name: \_\_\_\_\_

Title: \_\_\_\_\_

Tenant:

**Signature Behavioral Hospital Operations, LLC**

By: \_\_\_\_\_

Print Name: \_\_\_\_\_

Title: \_\_\_\_\_